

# MOORESVILLE CROSSING II

HWY 150 @ MORRISON PLANTATION PARKWAY  
EXIT 36 OFF I-77 MOORESVILLE, NC 28117

GRADED PAD SITE  
AVAILABLE

**NS** New South  
Properties  
OF THE CAROLINAS, LLC

GRADED PAD SITE AVAILABLE - MOORESVILLE, NC

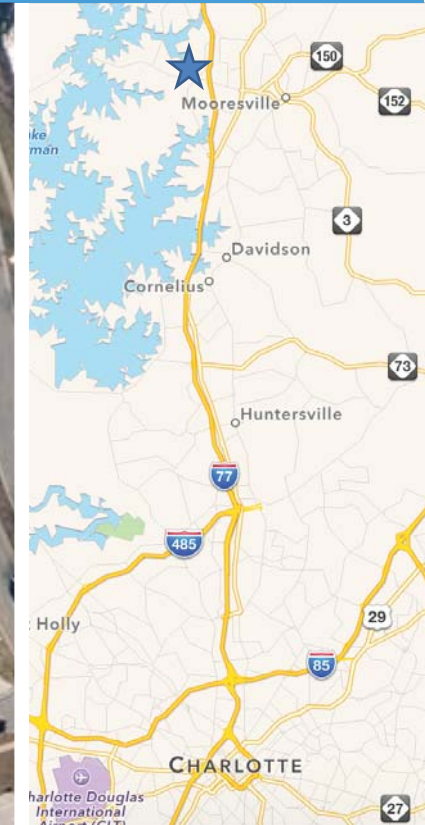

## PROPERTY INFORMATION

- +/- 72,900 SF Regional Shopping Center anchored by HH Gregg & Ashley Furniture
- Located on Hwy 150, the dominant commercial corridor off I-77 with strong national tenant mix
- High growth market with Mooresville/South Iredell County populations to grow by 47% between 2010 and 2030

## PROPERTY HIGHLIGHTS

- +/- 1.7 Acre Graded Pad Site with 5/1000 parking ratio
- Zoned up to 22,000 SF
- 90% of Site Work Complete
- Zoned – CMX (General Business District)
- For Sale or BT5

## BROKER CONTACT

PAULA SAUNDERS  
P 704 927 2892  
[psaunders@newsouthprop.com](mailto:psaunders@newsouthprop.com)

[NEWSOUTHPROP.COM](http://NEWSOUTHPROP.COM)



# MOORESVILLE CROSSING II

HWY 150 @ MORRISON PLANTATION PARKWAY  
EXIT 36 OFF I-77 MOORESVILLE, NC 28117

BROKER CONTACT PAULA SAUNDERS | P 704 927 2892 | psanders@newsouthprop.com



## AREA EMPLOYERS



## DEMOGRAPHICS

POPULATION	3 Miles: 25,554	5 Miles: 64,414	10 Miles: 155,939
AVG. H.H. INCOME	3 Miles: \$88,693	5 Miles: \$90,725	10 Miles: \$96,565
DAYTIME POP.	3 Miles: 20,257	5 Miles: 34,866	10 Miles: 70,441

# MOORESVILLE CROSSING II

HWY 150 @ MORRISON PLANTATION PARKWAY  
EXIT 36 OFF I-77 MOORESVILLE, NC 28117

BROKER CONTACT PAULA SAUNDERS | P 704 927 2892 | [psaunders@newsouthprop.com](mailto:psaunders@newsouthprop.com)

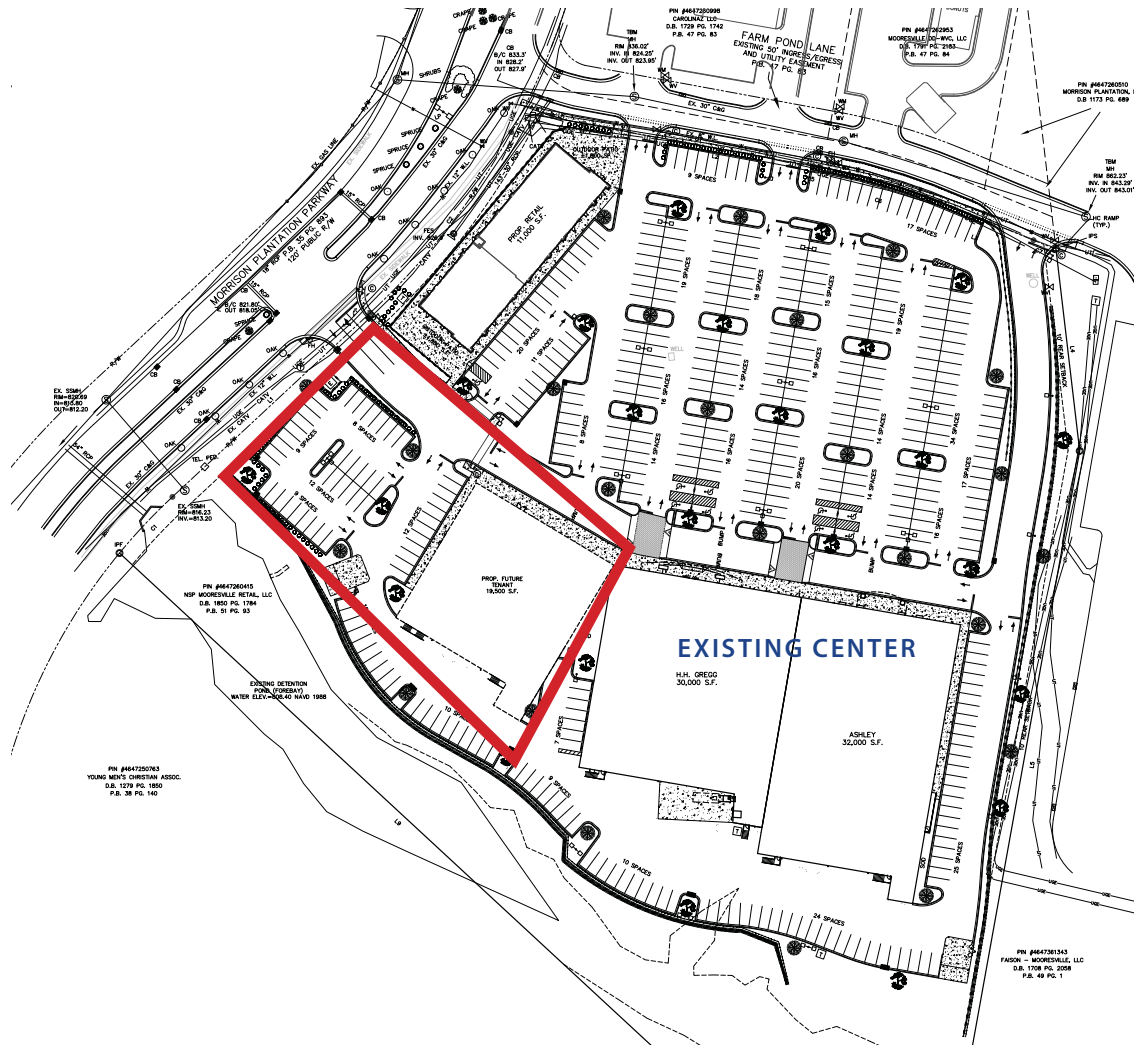

CONCEPTUAL  
OPTION 1-RETAIL



# MOORESVILLE CROSSING II

HWY 150 @ MORRISON PLANTATION PARKWAY  
EXIT 36 OFF I-77 MOORESVILLE, NC 28117

BROKER CONTACT PAULA SAUNDERS | P 704 927 2892 | [psaunders@newsouthprop.com](mailto:psaunders@newsouthprop.com)

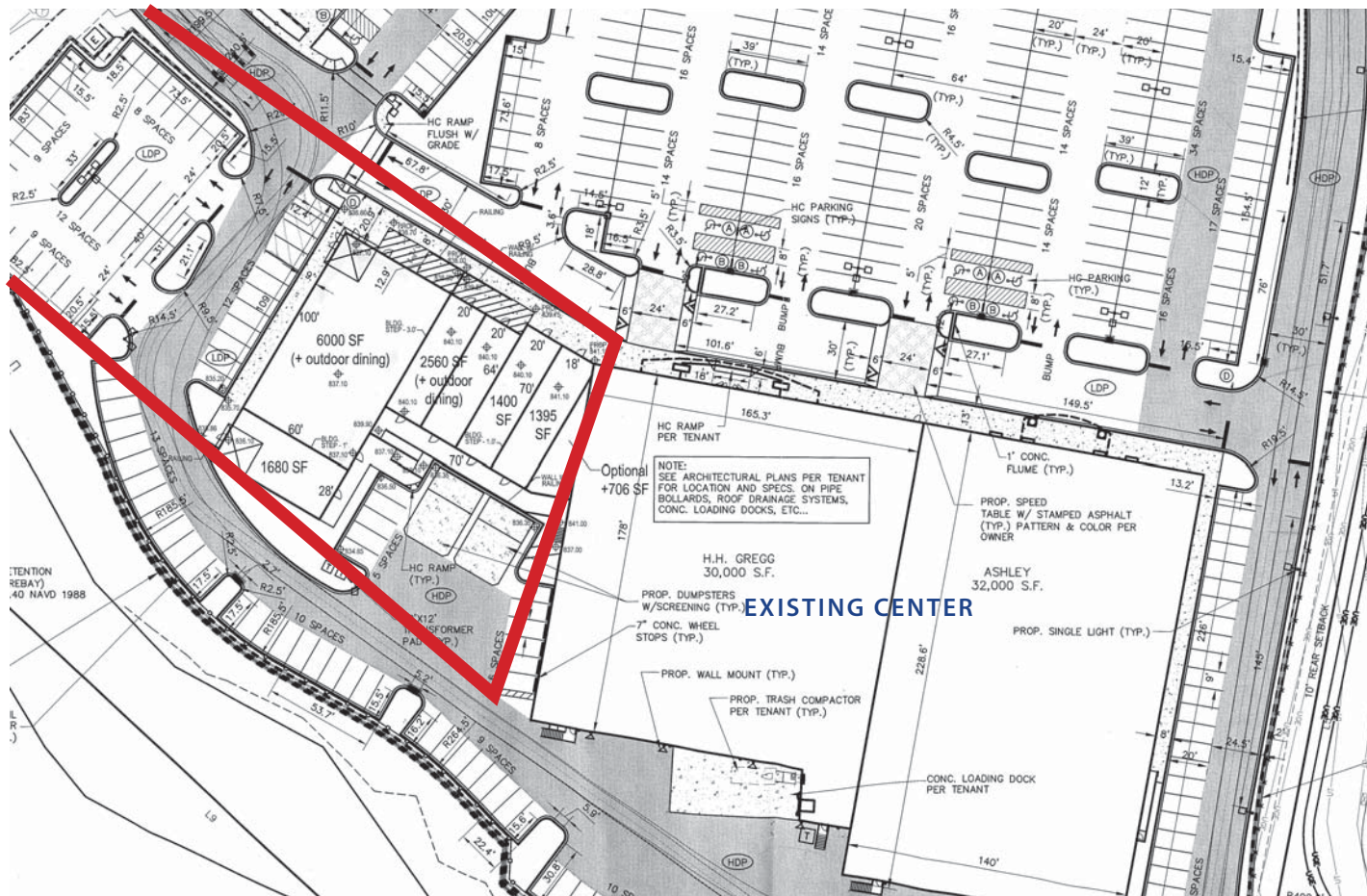

CONCEPTUAL  
OPTION 2 - RETAIL



# MOORESVILLE CROSSING II

HWY 150 @ MORRISON PLANTATION PARKWAY  
EXIT 36 OFF I-77 MOORESVILLE, NC 28117

**BROKER CONTACT** PAULA SAUNDERS | P 704 927 2892 | [psaunders@newsouthprop.com](mailto:psaunders@newsouthprop.com)

## AREA HIGHLIGHTS

- Lake Norman is the largest lake in North Carolina bringing in \$23 million in tourism every year
- Mooresville NC is part of the Lake Norman community and is central to some of the best outdoor recreational activities in NC
- 28117 zip code was ranked in the "Top Ten" for the "Charlotte Area's Wealthiest Zip Codes" and ranked Number Three for "Most Expensive Homes." (Charlotte Business Journal)
- Home to Trump National Charlotte Golf and Lake Club located off Brawley School Rd.
- Also known as "Race City USA," Mooresville is home to many of NASCAR's most prominent teams

