

111 58th Street

Sunset Park | Brooklyn

18,000 sf available

LOCATION: NE CORNER OF 58TH STREET AND 1ST AVENUE



Ground Floor:	500 SF (Lobby)
Second Floor:	17,500 SF
Frontage:	175 FT on 1 st Avenue 100 FT on 58 th Street
Ceiling Height:	16 FT - 35 FT
Zoning:	M3-1

HIGHLIGHTS:

- Dedicated lobby entrance with private elevator and stairs to second floor
- Fire sprinkler system installed
- Directly across from NYC Ferry landing and Brooklyn Army Terminal
- Located in the center of NYU Langone Medical Center development



OLMSTED
REAL ESTATE

111 58th Street

Sunset Park | Brooklyn

Floorplan – Second Floor

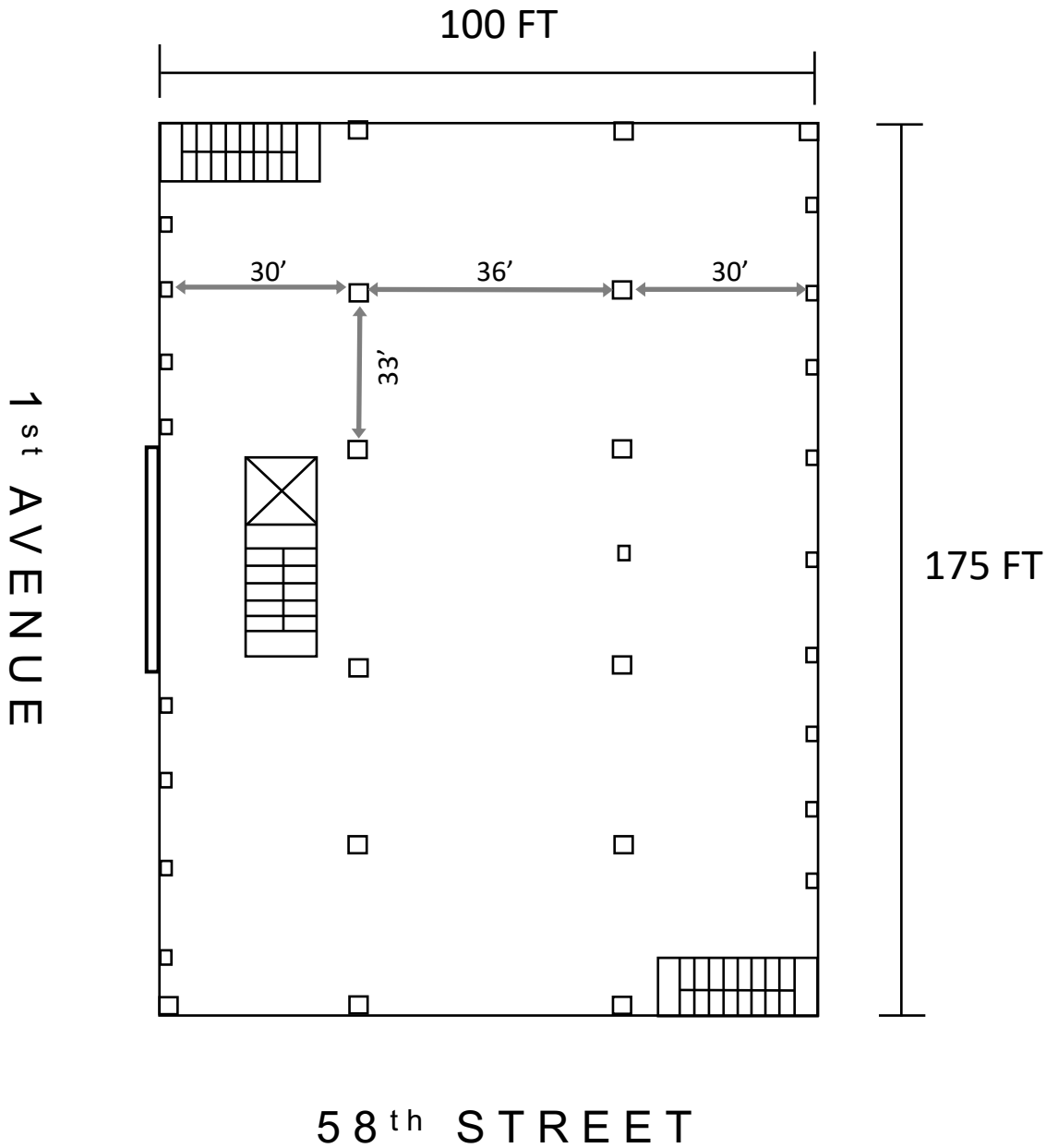

111 58th Street

Sunset Park | Brooklyn



In 2015, Lutheran Medical Center became affiliated with NYU Langone Medical Center and officially renamed NYU Langone Hospital – Brooklyn. Since the inception, NYU continued to expand its footprint in the neighborhood providing additional medical services to the community.

South Brooklyn Ferry Terminal

Brooklyn Army Terminal

5610 Second Avenue – Women’s health and pediatric care are provided at the 50,000 sf Sunset Park Family Health Center.

5718 Second Avenue – a new 28,700 sf facility as a center for chemotherapy and radiation therapies.



South Brooklyn Ferry Terminal is located directly across the street.



trains are located three blocks away at 59th Street station with 5,326,789 annual ridership. Another at 53rd Street station with 1,187,907 annual ridership.



111 58th Street

Sunset Park | Brooklyn

Interior Photos



contact exclusive leasing team



Harrison Baliksy
516-672-4493
hb@olmstedre.com

Keat Chew
347-571-3338
kc@olmstedre.com

Aaron Lee
469-442-9897
al@olmstedre.com

All information is from sources deemed reliable. No representation is made and we do not guarantee the accuracy of any information provided. All information must be independently verified. The value of any real estate investment is dependent on a variety of factors and should be evaluated carefully by prospective purchasers/ or tenants.