



2636 EDENBORN AVENUE

METAIRIE, LA 70002

OFFICE/
WAREHOUSE

FOR LEASE



LOCATION: 2636 Edenborn Avenue
Metairie, LA 70002

AVAILABLE SPACE: 10,000 SF – 16,000 SF

RENT: \$10 per SF

LEASE TYPE: NNN

ZONING: BC2

AGE: Renovated in 2016

PARKING: 20+ parking spaces

SITE INFORMATION

Unique and rare opportunity for a warehouse + office/showroom combination very close to the Veterans Memorial Blvd retail corridor, located on Edenborn Avenue behind Lowes. Up to approximately 16,000 sq ft of warehouse space with office/showroom available. Renovated in 2016 with Grade Level loading and 14' to 19' eaves.

DEMOGRAPHICS

DRIVE TIME	TOTAL POPULATION	TOTAL # HOUSEHOLDS	MEDIAN HH INCOME	AVERAGE HH INCOME
5 MINUTES	14,897	6,474	\$43,526	\$62,453
10 MINUTES	109,219	48,457	\$53,208	\$81,990
15 MINUTES	318,076	134,472	\$44,941	\$70,793

MSA: NEW ORLEANS - METAIRIE

AVAILABLE IMMEDIATELY

CONTACT: cholmes@srsa-realestate.com

504-831-2363
SRSAcommercial.com

2555 Severn Avenue
 Suite 200
 Metairie, LA 70002

Collin S. Holmes
 504-620-0356
cholmes@srsa-realestate.com





2636 EDENBORN AVENUE METAIRIE, LA 70002

OFFICE/
WAREHOUSE

FOR LEASE

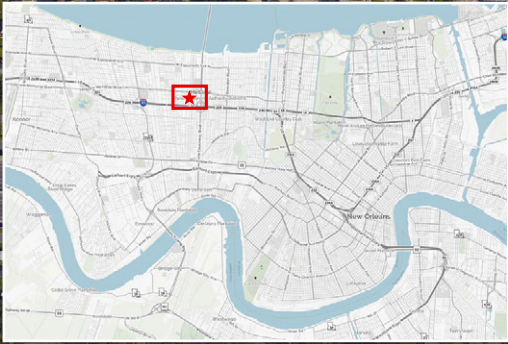

MSA: NEW ORLEANS - METAIRIE

AVAILABLE IMMEDIATELY

CONTACT: cholmes@srsa-realestate.com

504-831-2363

SRSCommercial.com



2555 Severn Avenue
Suite 200
Metairie, LA 70002

Collin S. Holmes
504-620-0356
cholmes@srsa-realestate.com





2636 EDENBORN AVENUE

METAIRIE, LA 70002

OFFICE/
WAREHOUSE **FOR LEASE**

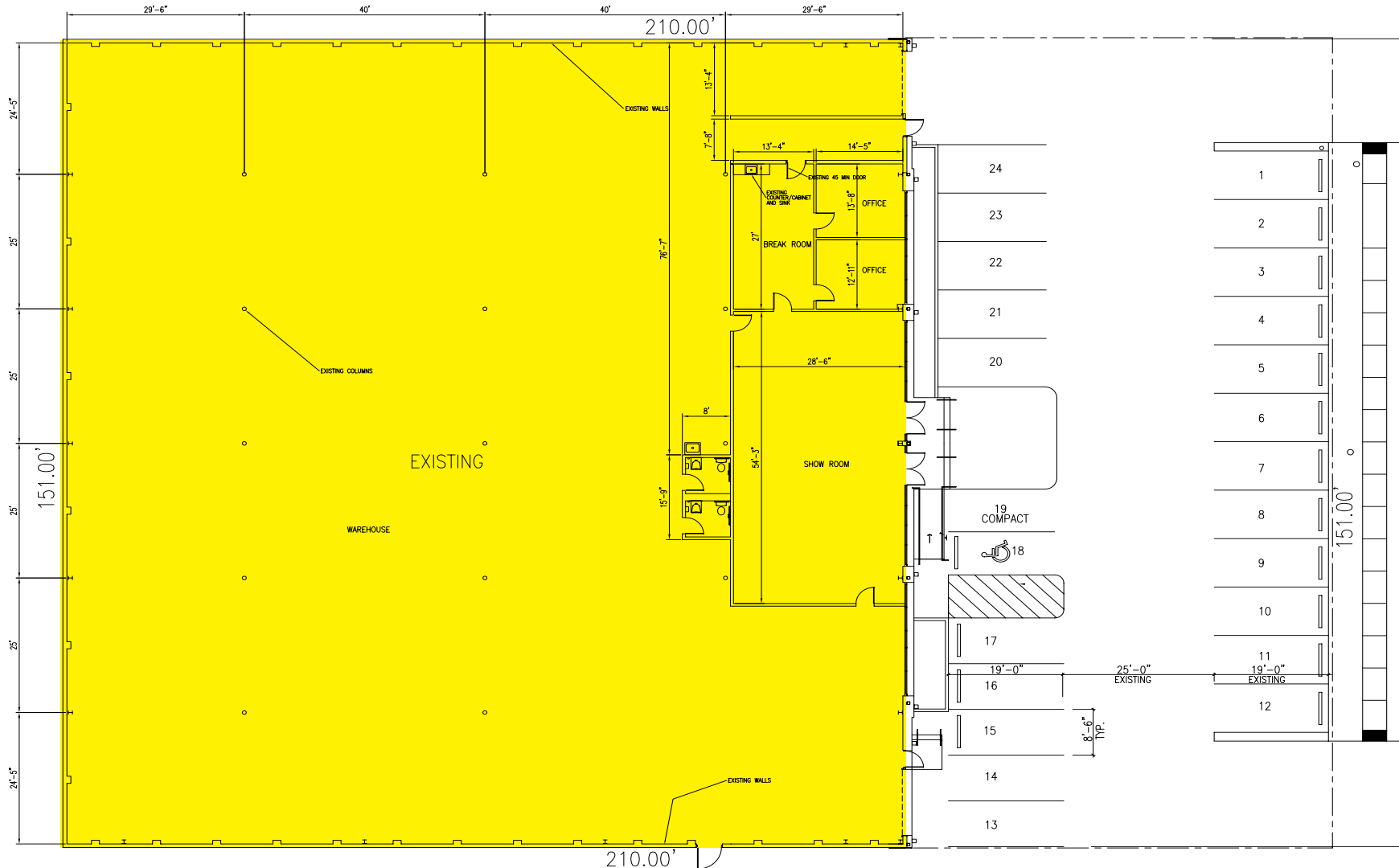

SCHEMATIC EXISTING FLOOR PLAN- 2636 edenborne
SCALE: 1/8" = 1'-0"

MSA: NEW ORLEANS - METAIRIE

AVAILABLE IMMEDIATELY

CONTACT: cholmes@srsa-realestate.com

504-831-2363

SRSCommercial.com



2555 Severn Avenue
Suite 200
Metairie, LA 70002

Collin S. Holmes
504-620-0356
cholmes@srsa-realestate.com





2636 EDENBORN AVENUE
METAIRIE, LA 70002

OFFICE/
WAREHOUSE

FOR LEASE



MSA: NEW ORLEANS - METAIRIE

AVAILABLE IMMEDIATELY

CONTACT: cholmes@srsa-realestate.com

504-831-2363

SRSCommercial.com



2555 Severn Avenue
Suite 200
Metairie, LA 70002

Collin S. Holmes
504-620-0356
cholmes@srsa-realestate.com

SRS A COMMERCIAL
REAL ESTATE

Customer Information Form

What Customers Need to Know When Working With Real Estate Brokers or Licensees

This document describes the various types of agency relationships that can exist in real estate transactions.

AGENCY means a relationship in which a real estate broker or licensee represents a client by the client’s consent, whether expressed or implied, in an immovable property transaction. An agency relationship is formed when a real estate licensee works for you in your best interest and represents you. Agency relationships can be formed with buyers/sellers and lessors/lessees.

DESIGNATED AGENCY means the agency relationship that shall be presumed to exist when a licensee engaged in any real estate transaction, except as otherwise provided in LA R.S. 9:3891, is working with a client, unless there is a written agreement providing for a different relationship.

- The law presumes that the real estate licensee you work with is your designated agent, unless you have a written agreement otherwise.
- No other licensees in the office work for you, unless disclosed and approved by you.
- You should confine your discussions of buying/selling to your designated agent or agents only.

DUAL AGENCY means an agency relationship in which a licensee is working with both buyer and seller or both landlord and tenant in the same transaction. Such a relationship shall not constitute dual agency if the licensee is the seller of property that he/she owns or if the property is owned by a real estate business of which the licensee is the sole proprietor and agent. A dual agency relationship shall not be construed to exist in a circumstance in which the licensee is working with both landlord and tenant as to a lease that does not exceed a term of three years and the licensee is the landlord. Dual agency is allowed only when informed consent is presumed to have been given by any client who signed the dual agency disclosure form prescribed by the Louisiana Real Estate Commission. Specific duties owed to both buyer/seller and lessor/lessee are:

- To treat all clients honestly.
- To provide factual information about the property.
- To disclose all latent material defects in the property that are known to them.
- To help the buyer compare financing options.
- To provide information about comparable properties that have sold, so that both clients may make educated buying/selling decisions.
- To disclose financial qualifications to the buyer/lessee to the seller/lessor.
- To explain real estate terms.
- To help buyers/lessees arrange for property inspections
- To explain closing costs and procedures.

CONFIDENTIAL INFORMATION means information obtained by a licensee from a client during the term of a brokerage agreement that was made confidential by the written request or written instruction of the client or is information the disclosure of which could materially harm the position of the client, unless at any time any of the following occur:

- The client permits the disclosure by word or conduct.
- The disclosure is required by law or would reveal serious defect.
- The information became public from a source other than the licensee.

By signing below you acknowledge that you have read and understand this form and that you are authorized to sign this form in the capacity in which you have signed.

Buyer/Lessee:

Seller/Lessor:

By: _____

By: _____

Title: _____

Title: _____

Date: _____

Date: _____

Licensee: _____

Licensee: _____

Date: _____

Date: _____

