



FOR LEASE
2800 14th Avenue, Markham
Office opportunity in the Heart of Markham



OFFICE SPACE FROM 2,400 TO 5,585 SF



LOCATION:

Woodbine Avenue and Fourteenth Avenue

AVAILABLE SPACE:

Suite 300 5,585 SF DIVISIBLE TO 2,000 SF
Suite 404 2,400 SF
Suite 405 1,650 SF

NET RENT:

\$10.00 PSF

ADDITIONAL RENT:

\$14.25 PSF

PARKING:

Underground and surface parking available

HIGHLIGHTS

- Fibre optics network
- Free underground & surface parking available
- Boardroom available for tenant's use
- Easy access to Highway 407 and Highway 404

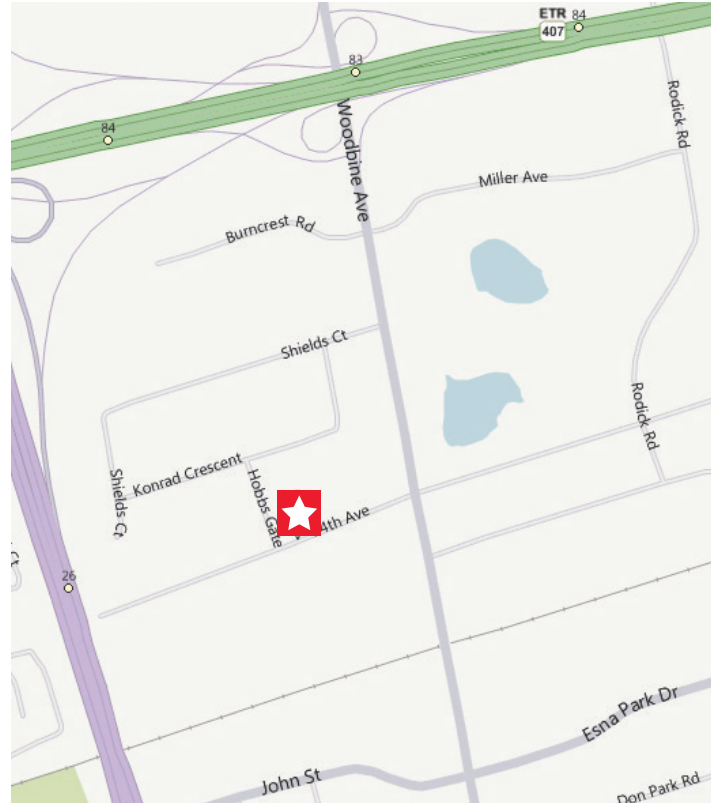

Zarko Stojanovic
Broker
Direct: 416 756 5440
zarko.stojanovic@cushwake.com

Cushman & Wakefield Ltd.
3100 Steeles Avenue East
Suite 1100
Markham, ON L3R 8T3



**CUSHMAN &
WAKEFIELD**

FOR LEASE

2800 14th Avenue, Markham

Office opportunity in the Heart of Markham

Suite 300
5,585 SF

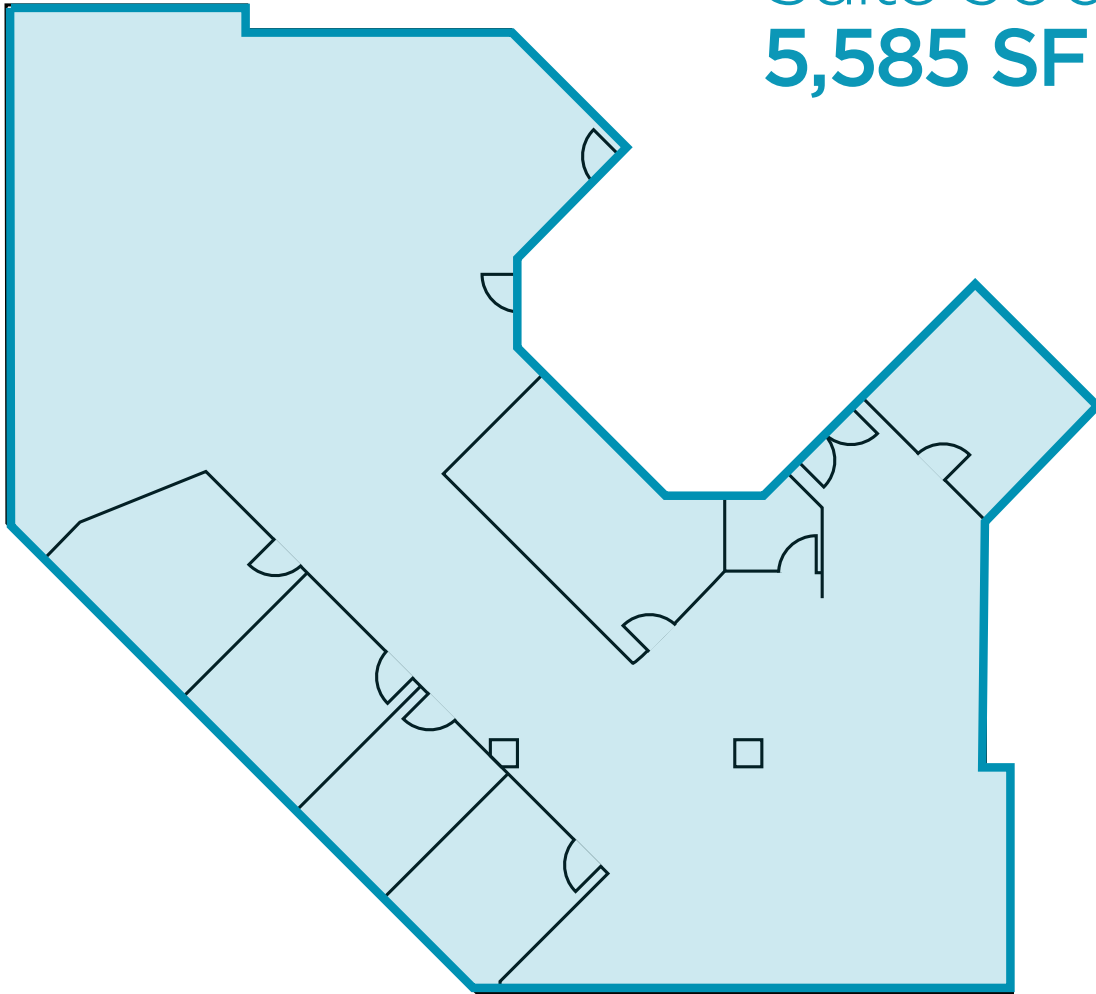

Zarko Stojanovic

Broker

Direct: 416 756 5440

zarko.stojanovic@cushwake.com

Cushman & Wakefield Ltd.

3100 Steeles Avenue East

Suite 1100

Markham, ON L3R 8T3

Cushman & Wakefield Ltd., Brokerage. Copyright © 2017.
No warranty or representation, expressed or implied, is
made as to the accuracy of the information contained
herein, and same is submitted subject to errors, omissions,
change of price, rental or other conditions, withdrawal
without notice, and to any specific listing condition,
imposed by our principals.



FOR LEASE

2800 14th Avenue, Markham

Office opportunity in the Heart of Markham

Suite 404 2,400 SF

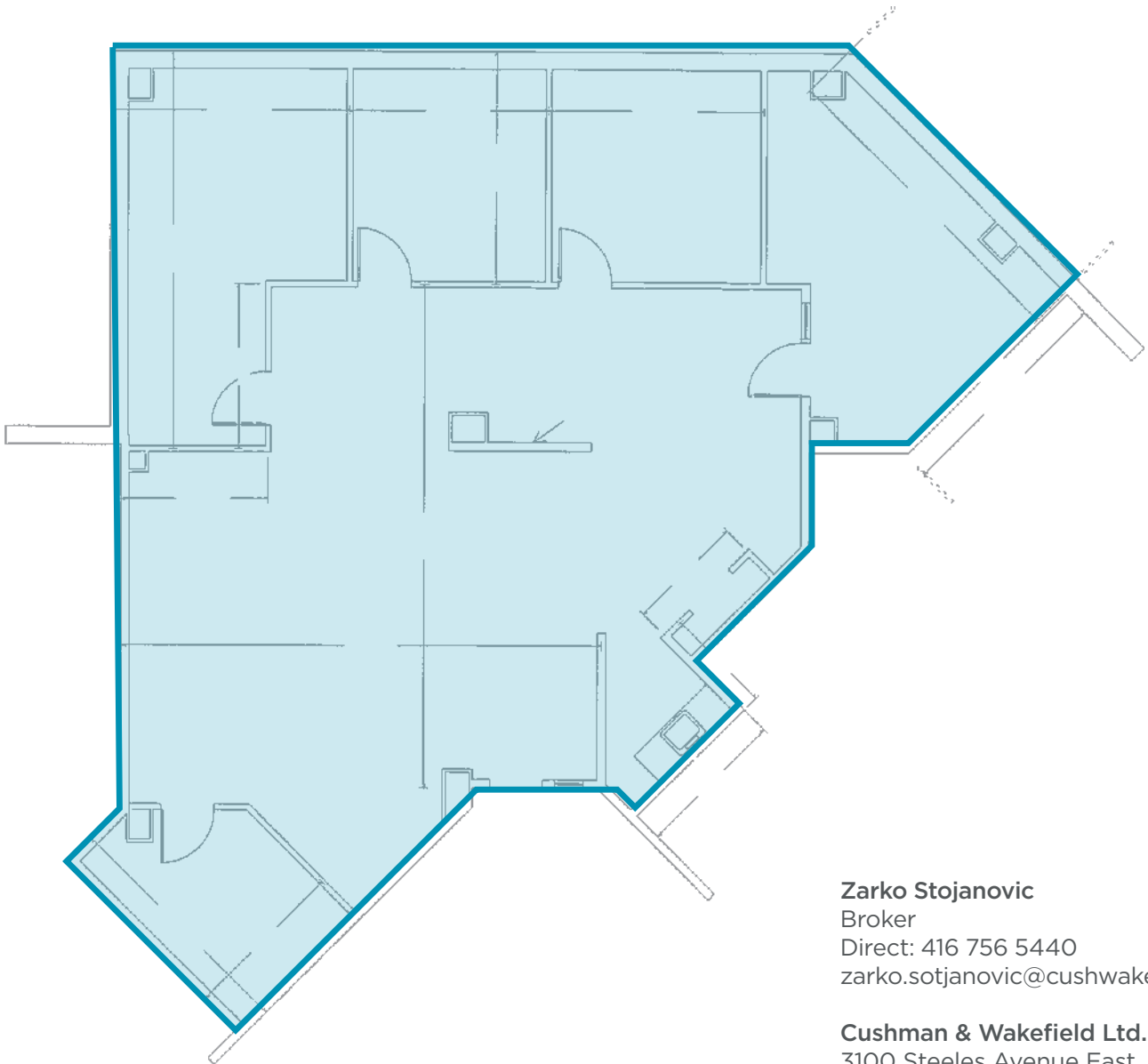

Zarko Stojanovic
Broker
Direct: 416 756 5440
zarko.stojanovic@cushwake.com

Cushman & Wakefield Ltd.
3100 Steeles Avenue East
Suite 1100
Markham, ON L3R 8T3

Cushman & Wakefield Ltd., Brokerage. Copyright © 2017.
No warranty or representation, expressed or implied, is made as to the accuracy of the information contained herein, and same is submitted subject to errors, omissions, change of price, rental or other conditions, withdrawal without notice, and to any specific listing condition, imposed by our principals.



**CUSHMAN &
WAKEFIELD**

FOR LEASE

2800 14th Avenue, Markham

Office opportunity in the Heart of Markham

Suite 405 1,650 SF

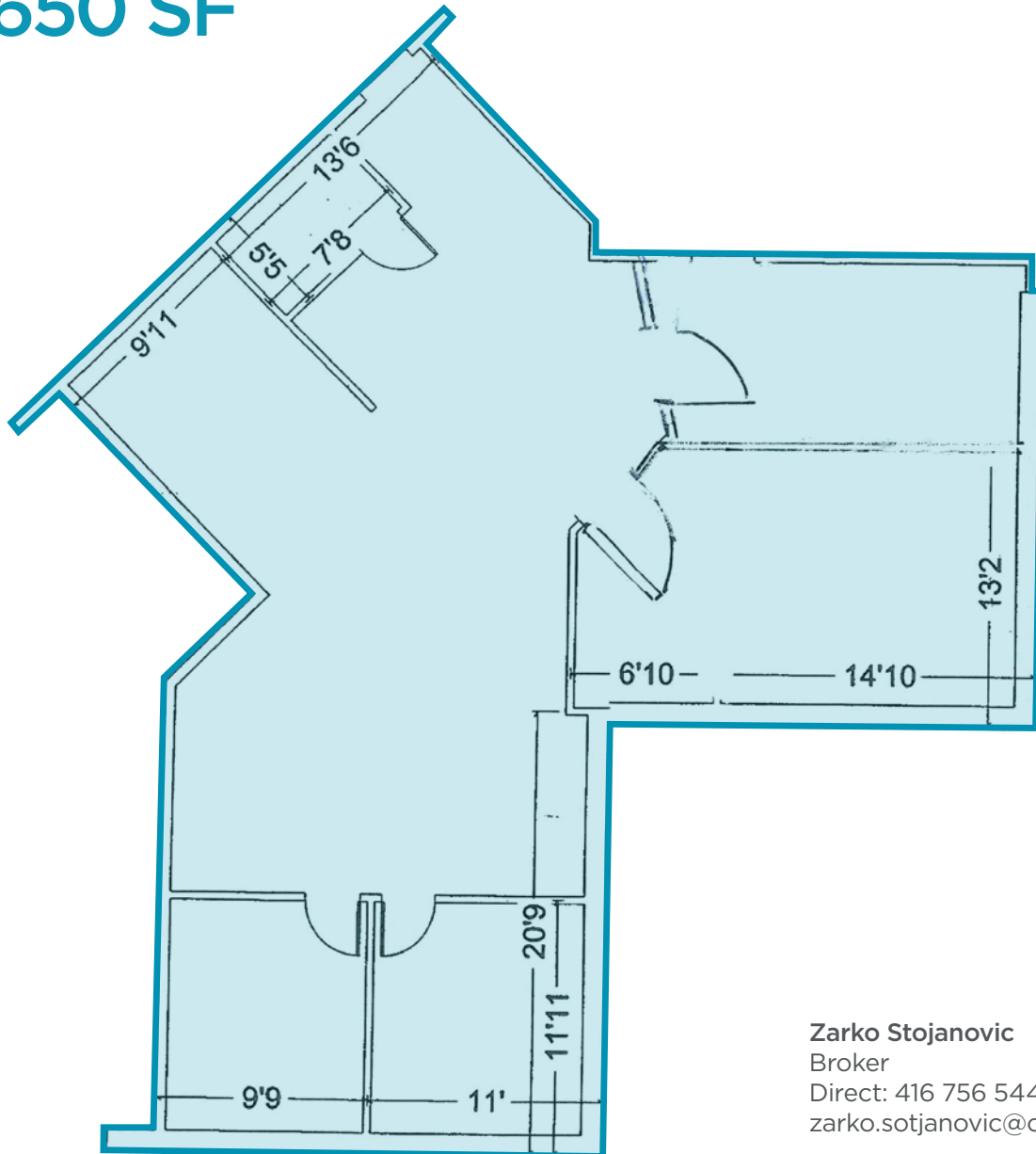

Zarko Stojanovic
Broker
Direct: 416 756 5440
zarko.sotjanovic@cushwake.com

Cushman & Wakefield Ltd.
3100 Steeles Avenue East
Suite 1100
Markham, ON L3R 8T3

Cushman & Wakefield Ltd., Brokerage. Copyright © 2017.
No warranty or representation, expressed or implied, is made as to the accuracy of the information contained herein, and same is submitted subject to errors, omissions, change of price, rental or other conditions, withdrawal without notice, and to any specific listing condition, imposed by our principals.