

# 64 WEST COLORADO BOULEVARD



# SPACE DETAILS

## LOCATION

South block between South De Lacey Avenue and Fair Oaks Avenue

## SPACE

Ground Floor	7,415 SF
Mezzanine	5,416 SF
Total	12,831 SF

## CEILING HEIGHT

Ground Floor	19 FT
Mezzanine	8.5 FT

## FRONTAGE

41 FT on West Colorado Boulevard

## TERM

10 years

## POSSESSION

Immediate

## SITE STATUS

Formerly H&M

## NEIGHBORS

Tiffany & Co., Apple, Nike, Footlocker/House of Hoops, Sephora, Zara, True Food Kitchen and M•A•C Cosmetics

## COMMENTS

Flagship retail opportunity ideally positioned on one of California's most visited streets

Up to 19-FT ceilings on the Ground Floor

Fully-usable Mezzanine offering 8.5-FT ceilings

## GROUND FLOOR

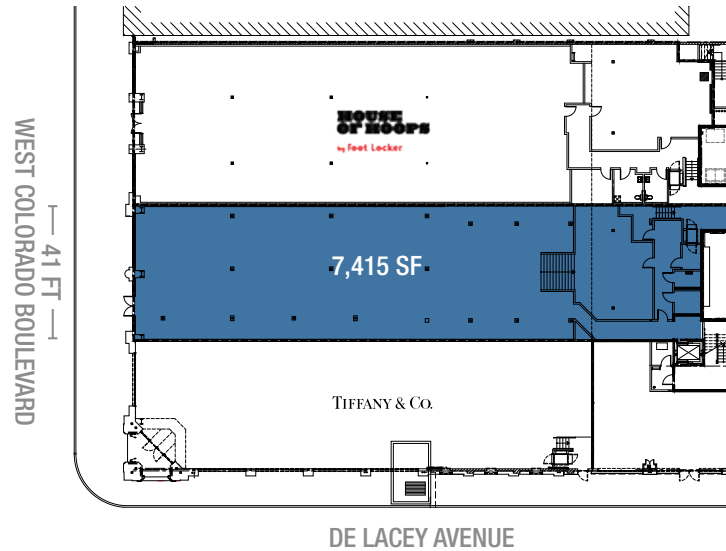

## MEZZANINE

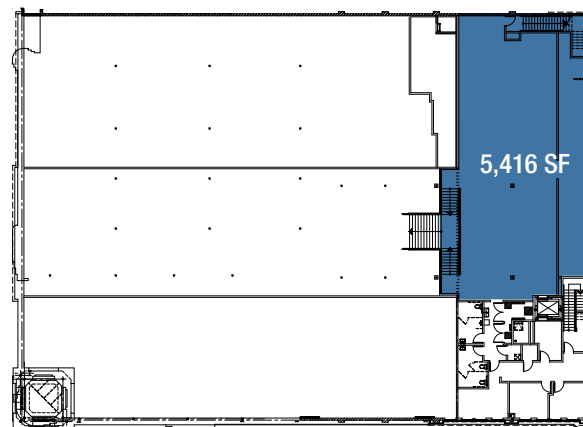

# AREA PHOTOS



# AREA RETAIL

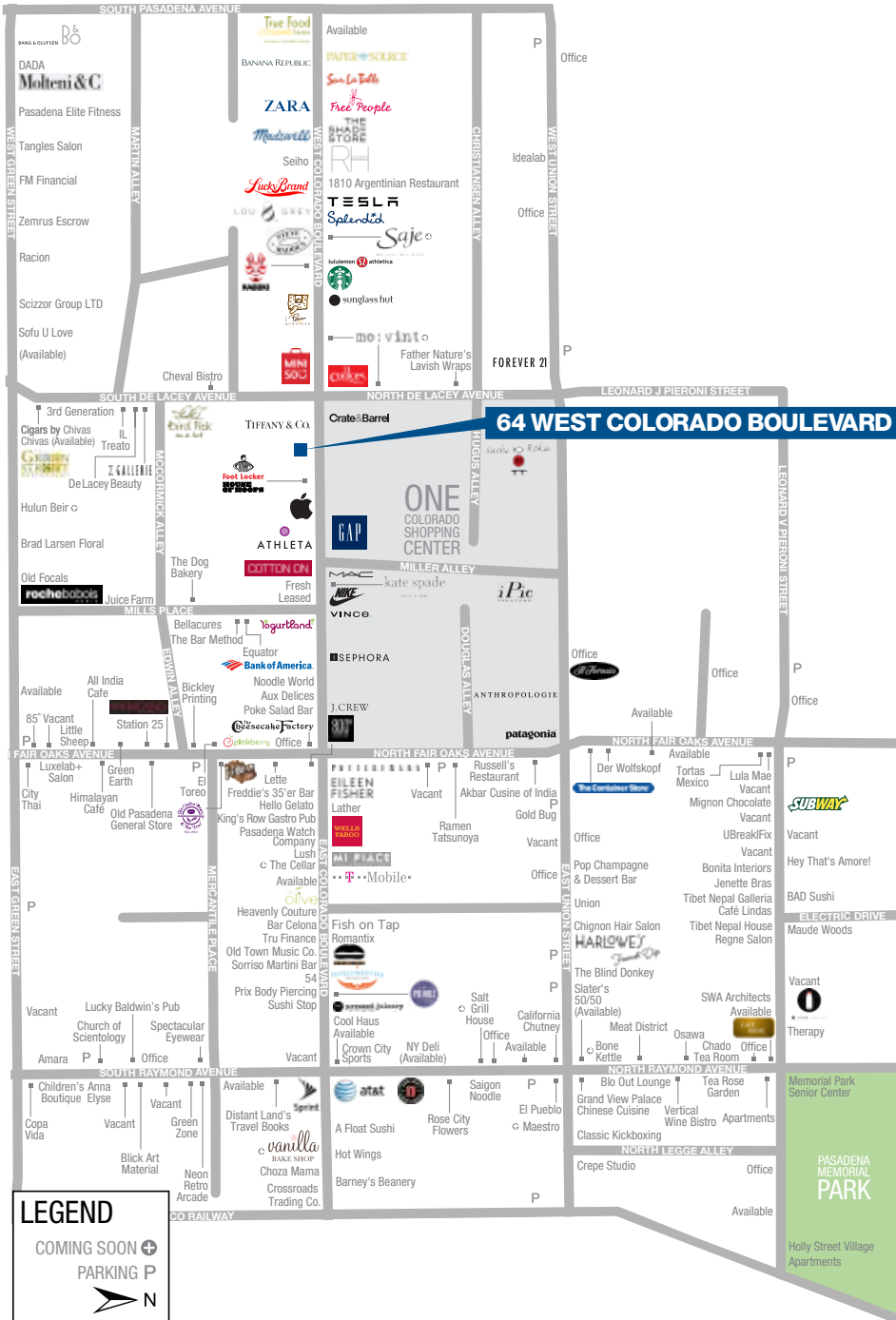

# AREA DEMOGRAPHICS

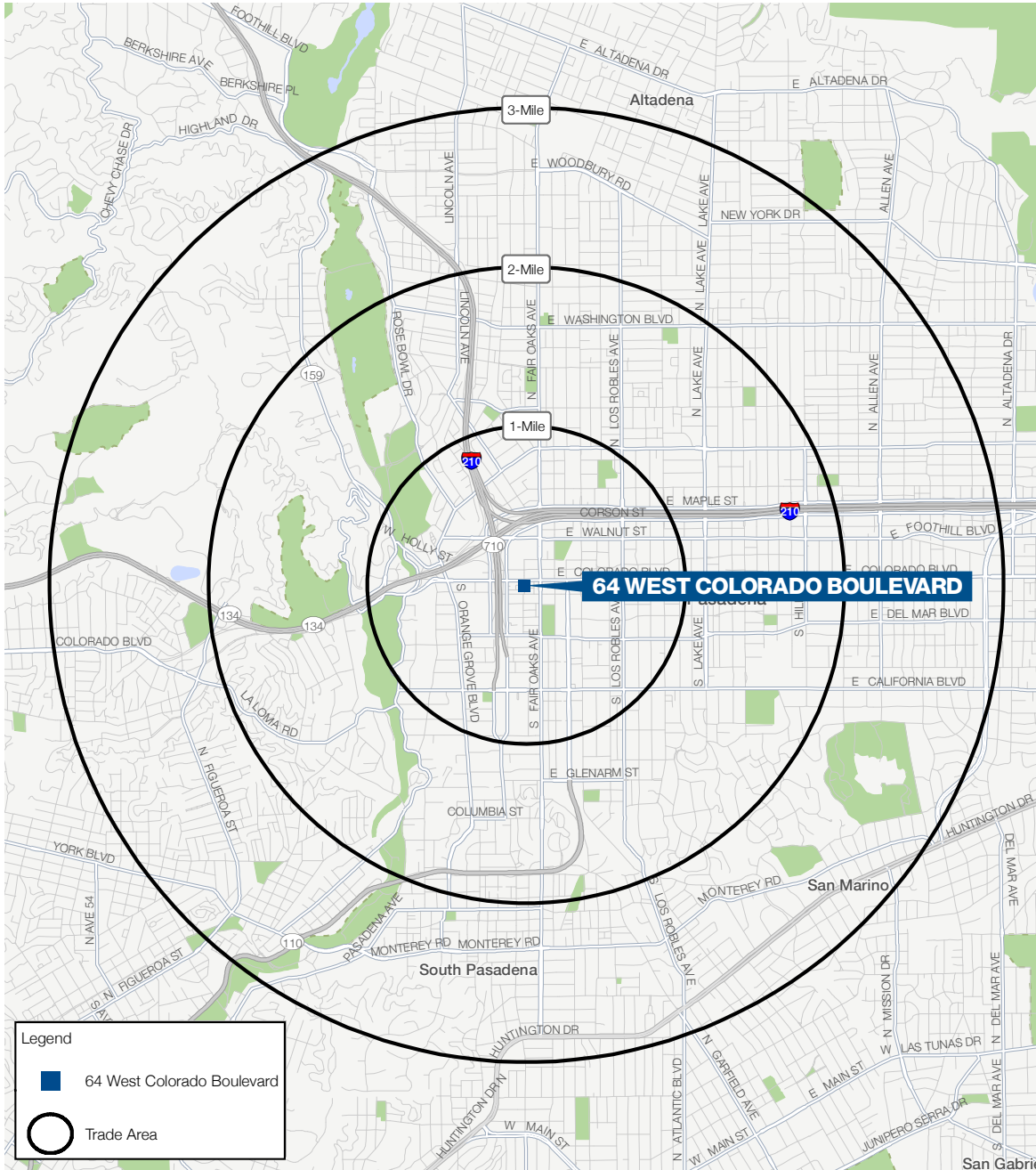

## ESTIMATED DAYTIME POPULATION

1 mile	58,046
2 miles	144,975
3 miles	223,409

## AVERAGE HOUSEHOLD INCOME

1 mile	\$94,821
2 miles	\$97,858
3 miles	\$105,138

## TOTAL HOUSEHOLDS

1 mile	14,091
2 miles	39,781
3 miles	76,275

## TOTAL APPAREL

1 mile	\$2,689
2 miles	\$2,736
3 miles	\$2,875

## FOOD AT RESTAURANTS

1 mile	\$3,880
2 miles	\$3,894
3 miles	\$4,059

2016 numbers

**64 WEST COLORADO BOULEVARD**  
PASADENA CA

**CONTACT**  
EXCLUSIVE  
AGENTS

**ROBERT COHEN**  
LIC #01800848  
310.593.0770  
rcohen@rkf.com

**KRISTIN MCCANN**  
LIC #01934727  
310.593.0755  
kmccann@rkf.com

**ROBERT URY**  
LIC #01767689  
310.593.0765  
rury@rkf.com



**233 WILSHIRE BOULEVARD**  
SUITE 310  
SANTA MONICA, CA 90401  
310.593.0777 | INFO@RKF.COM | RKF.COM

© 2017 RKF GROUP CALIFORNIA, INC. All information is from sources believed reliable, not independently verified, and thus subject to errors, omissions, and modifications such as price, listing, square footage, rates and commissions. All information, estimates and projections subject to change, market assumptions, unknown facts and conditions, and future potentialities. RKF makes no express or implied representations or warranties, as facts and results may vary materially from all information, estimates and projections. LIC# 01796698

All renderings presented are conceptual.