

6695 HIGHLAND ROAD
WATERFORD, MICHIGAN

OFFICE FOR LEASE
300-4,163 Square Feet Available



**SIGNATURE
ASSOCIATES**
KNOW SIGNATURE | KNOW RESULTS

OFFICE/MEDICAL BUILDING



PROPERTY FEATURES

- 300-4,163 square feet available
- 15,000 total building square footage
- Extraordinarily well-maintained office/medical building
- Located across from the entrance to Oakland County Airport
- Excellent opportunity to start your business
- Outside storage units available to rent for \$150/month Gross
- Lease Rate: \$17.00/ Gross

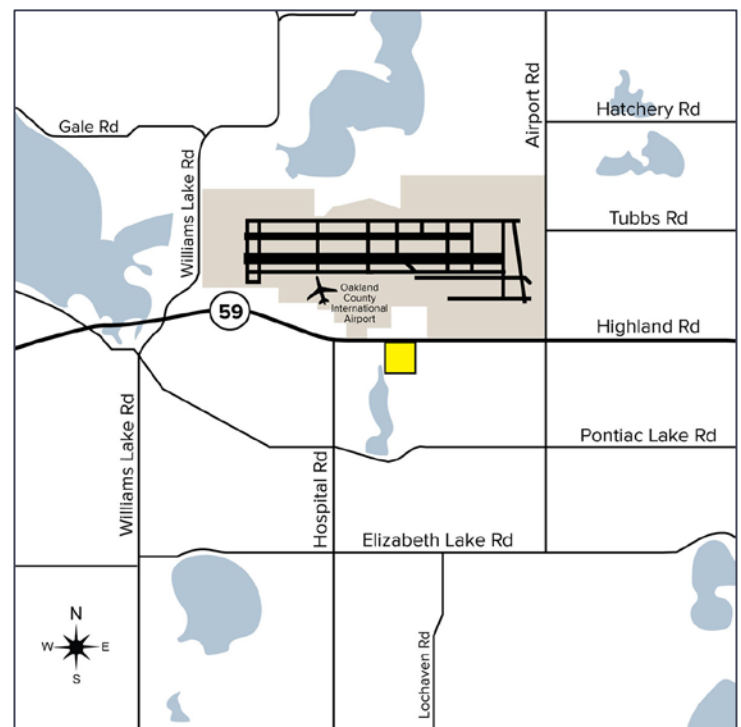

For more information, please contact:

MARVIN PETROUS
(248) 359 0647

mpetrous@signatureassociates.com

ANGELA THOMAS
(248) 359 3838

athomas@signatureassociates.com

SIGNATURE ASSOCIATES
One Towne Square, Suite 1200
Southfield, MI 48076
www.signatureassociates.com

Site Plan

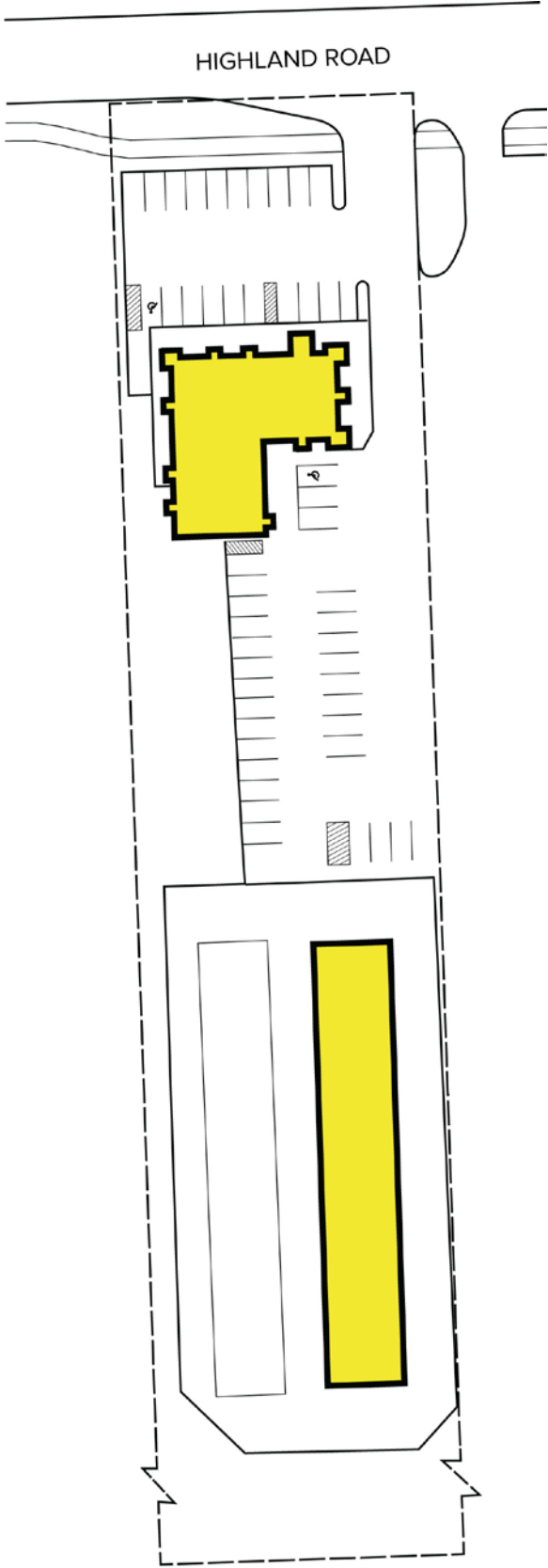

For more information, please contact:

MARVIN PETROUS
(248) 359 0647
mpetrous@signatureassociates.com

ANGELA THOMAS
(248) 359 3838
athomas@signatureassociates.com

SIGNATURE ASSOCIATES
One Towne Square, Suite 1200
Southfield, MI 48076
www.signatureassociates.com

6695 Highland Road – Waterford, Michigan
Office For Lease

300 – 4,163
Square Feet
AVAILABLE

Aerial



For more information, please contact:

MARVIN PETROUS

(248) 359 0647

mpetrous@signatureassociates.com

ANGELA THOMAS

(248) 359 3838

athomas@signatureassociates.com

SIGNATURE ASSOCIATES

One Towne Square, Suite 1200

Southfield, MI 48076

www.signatureassociates.com