

2032 E. SQUARE LAKE RD
TROY, MICHIGAN

OFFICE FOR LEASE
180 - 572 Square Feet Available



**SIGNATURE
ASSOCIATES**
KNOW SIGNATURE | KNOW RESULTS

NORTH TROY OFFICE PLACE



PROPERTY FEATURES

- Executive office space
- 180-572 square feet contiguous suites
- Individual executive suites available (1 year minimum lease)
- Attractive high image building situated on corner lot
- Excellent visibility and signage
- Ample parking with 4.05/1,000 square feet
- Class B, 1-Story 11,124 square foot building

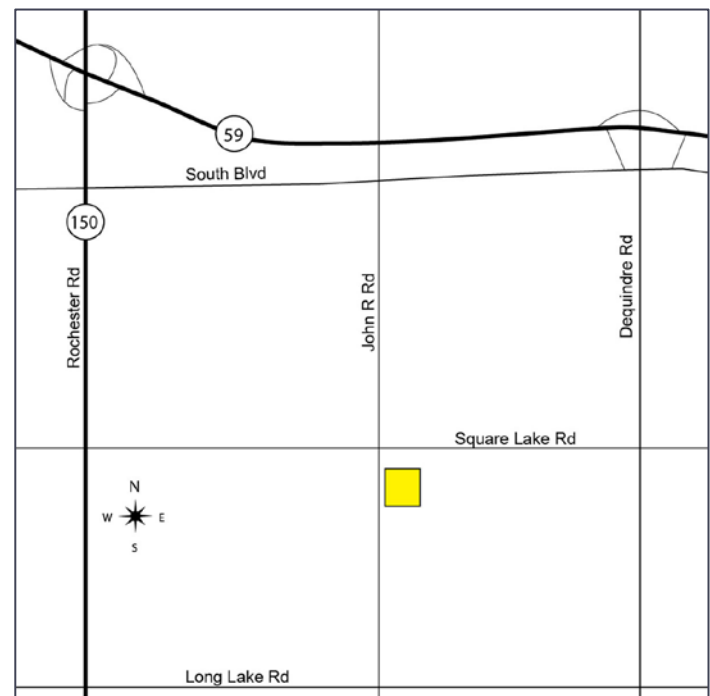

For more information, please contact:

DAVE MILLER
(248) 948 4183

dmliller@signatureassociates.com

CHRIS MONSOUR
(248) 948 0107

cmonsour@signatureassociates.com

SIGNATURE ASSOCIATES
One Towne Square, Suite 1200
Southfield, MI 48076
www.signatureassociates.com

2032 E. Square Lake Road – Troy, Michigan

Office For Lease

180 – 572
Square Feet
AVAILABLE

Floor Plan

SUITE	SF	PRICE
Individual Suites:		
200-B	180	\$600/Month
200-C	180	\$600/Month
200-D	212	\$750/Month

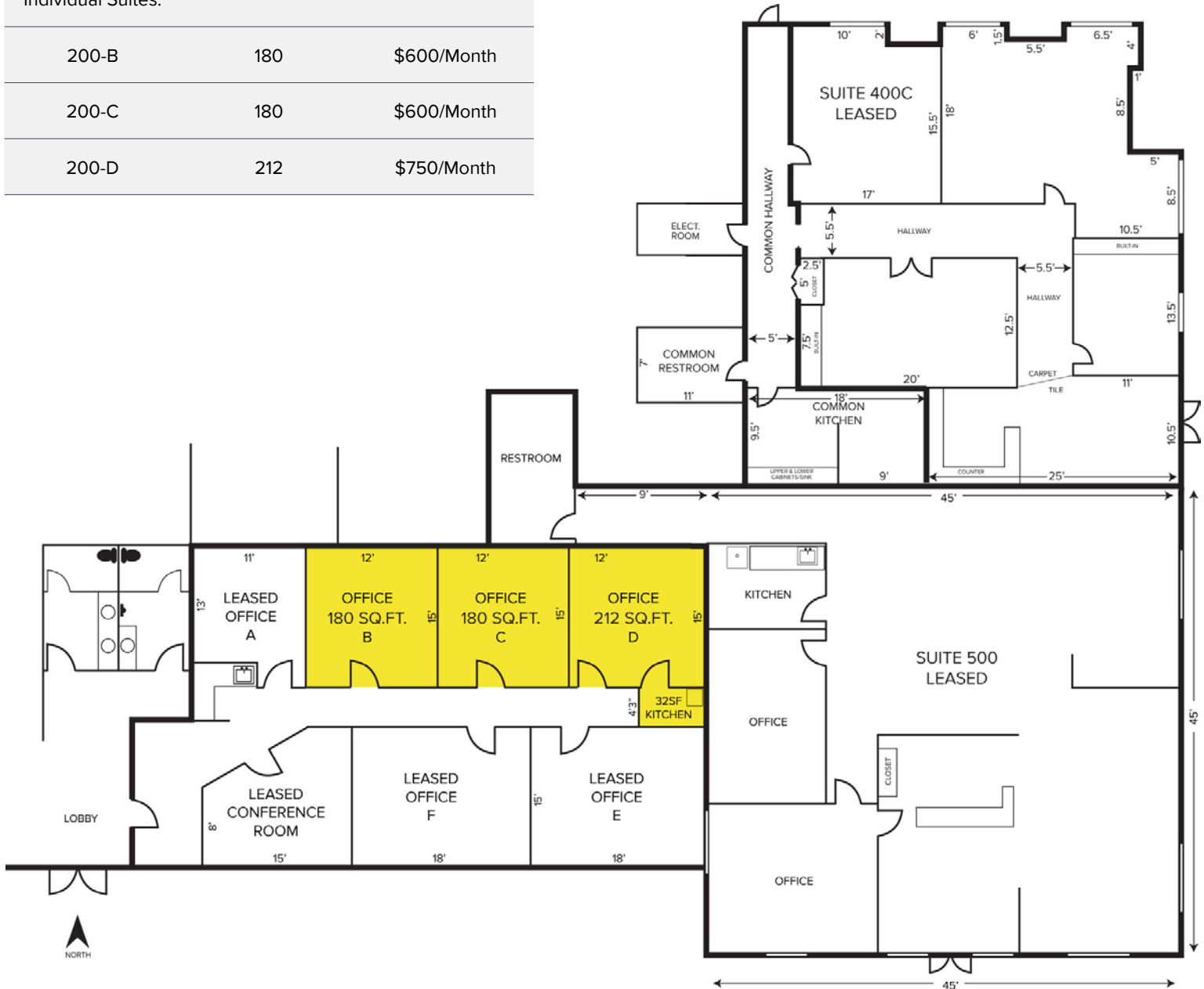

For more information, please contact:

DAVE MILLER
(248) 948 4183

dmiller@signatureassociates.com

CHRIS MONSOUR
(248) 948 0107

cmonsour@signatureassociates.com

SIGNATURE ASSOCIATES
One Towne Square, Suite 1200
Southfield, MI 48076
www.signatureassociates.com