

LEVI STRAUSS BUILDING
1809 Cherry St.
Knoxville, TN 37917
Knox County



Property Type: Warehousing and Manufacturing

Available: 180,000 square feet
(Can Be Divided)

Lease Rate: \$2.25 PSF-Modified Gross
(Rate Includes Taxes & Insurance)



Building Information

SQ/FT: 180,000 (Divisible)

All Utilities: Yes

Construction: Concrete Block

Ceiling Heights: 9'5" - 12'5"

Loading Docks: Yes (1)

Drive in Doors: Yes (2)

Property Description:

Building can be divided into 24k, 36k, 48k or 72k sq.ft. increments per floor plan. Building improved with concrete floors with vinyl tile, concrete block walls, built-up asphalt roof, utilities- water, gas and sewer- provided by KUB. Electric includes 4000 amp, 277/480 volt, 3 phase, 4 wire. Wet sprinkler system, HVAC and gas heat. Column spacing of 30' x 30'. Ceiling height varies from 9'5" to 12'5". Building also contains (1) 8' x 7' dock and (2) 9' x 9' high van-high doors. Excellent access, the building is considered a central city location approximately (1) mile from downtown Knoxville, East off I-40, approximately (.2) miles via Cherry Street exit. The building is situation on the corner of Cherry Street and Hoitt Avenue. Majority of surrounding uses are industrial in nature.



CONTACT

Bob Thornton, SIOR
Baker Realty Company
Knoxville, TN
(865)450-2999

(865)450-2910 - fax

bobthornton@bakerrealtycompany.com

www.bakerrealtycompany.com



This information has been secured from sources we believe to be reliable, but we make no representation or warranties, expressed or implied, as to the accuracy of the information. All references to age, sq. footage, income, and expenses are approximate. Buyers should conduct their own independent investigations and rely only on those results.

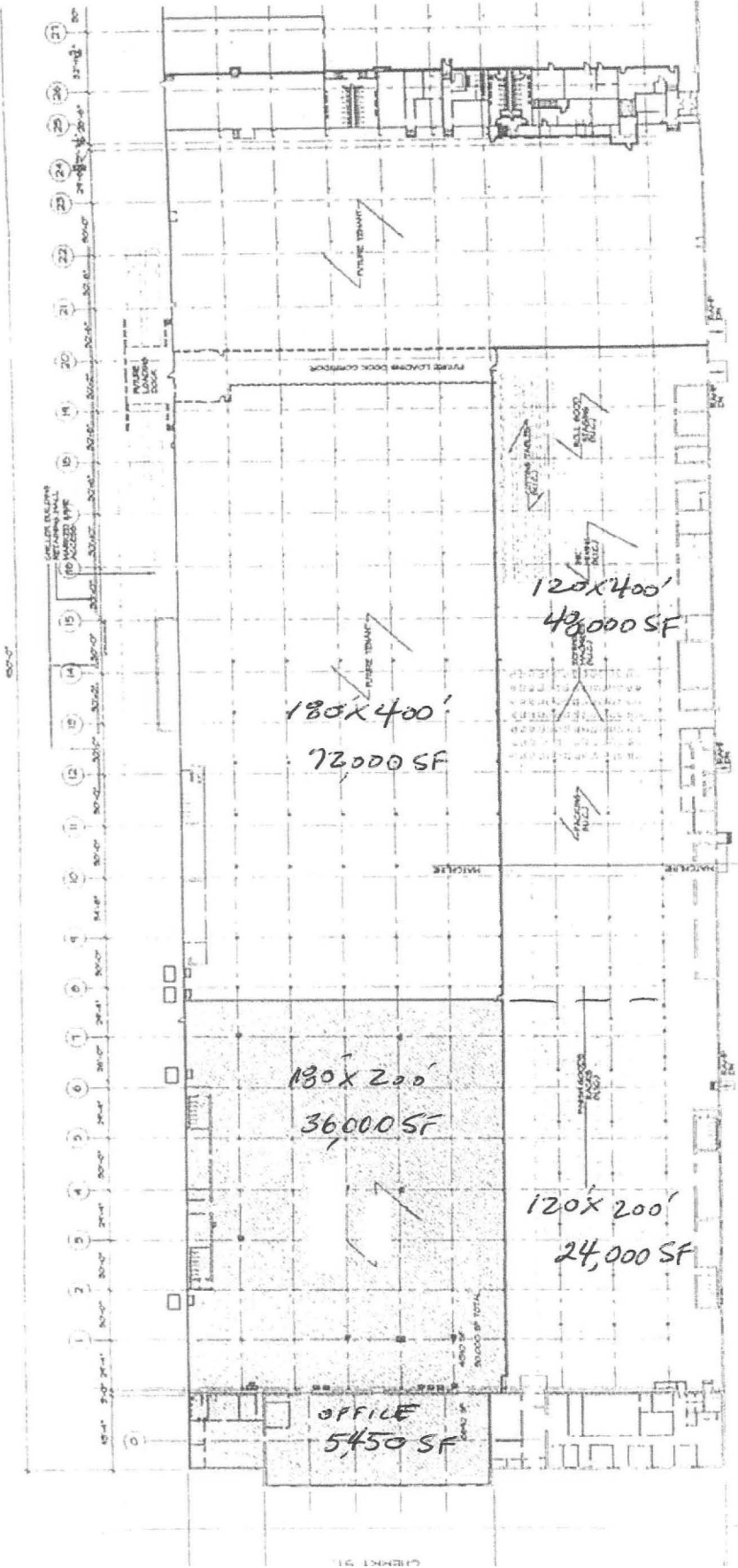

PROJECT DATA	RS-443
ARCHITECT'S FILE NO.	TYPE IV
CONSTRUCTION TYPE	UNPROTECTED SPRINKLED
OCCUPANCY	BUSINESS
NO. STORIES & HEIGHT	1 STORY HST = 14'
BUILDING AREA	281644 SQ. FT.
APPLIED CODES	IBC 1997 NFPA 1054 ADA 1990

1 FLOOR PLAN
SCALE 1/8" = 1'-0"