



# SEATAC CITY HALL

*Exclusively represented by*



**THE ANDOVER COMPANY, INC.**

C O R F A C I N T E R N A T I O N A L

**Mike Hemphill**

206-336-5325

[mhemphill@andoverco.com](mailto:mhemphill@andoverco.com)

**Mike Ewing**

206-357-5483

[mewing@andoverco.com](mailto:mewing@andoverco.com)



# BIRD'S EYE VIEW





# *DISTINCTIVE AND MODERN!*

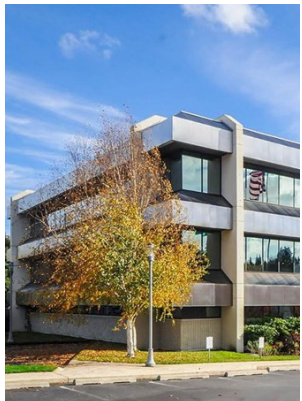

***SEA TAC CITY HALL*** offers modern Class A office space immediately off Interstate 5 at the S 188th/Orillia interchange. Tenants will find this exceptional office building only five minutes from SeaTac Airport. This quality office building offers convenient, immediate access to I-5 for employees and customers.

## ***HIGHLIGHTS***

- Three-story *Class A* 105,000 SF office building
- Immediate access to both northbound and southbound I-5 via the S 188<sup>th</sup> Street interchange
- Large, efficient floor plates (35,000 SF) divisible to 2,000 square feet
- State-of-the-art telecommunications service and data transmission with CenturyLink and Comcast Business cable; fiber optic capability on site
- 20 minutes to Seattle; 20 minutes to Tacoma; 5 minutes to SeaTac International Airport
- Metro bus route to building
- Security system with proximity card key access
- Tremendous territorial views of Mount Rainier
- Multitude of hotels and restaurants within a 5 minute drive

## ***FEATURES***

- |                       |                                                                                                                                                                                                                      |
|-----------------------|----------------------------------------------------------------------------------------------------------------------------------------------------------------------------------------------------------------------|
| <b>Typical floor:</b> | 35,000 SF                                                                                                                                                                                                            |
| <b>Parking:</b>       | Plentiful free parking                                                                                                                                                                                               |
| <b>Year built:</b>    | 1978                                                                                                                                                                                                                 |
| <b>Structure:</b>     | Reinforced concrete and glass                                                                                                                                                                                        |
| <b>Elevators:</b>     | One passenger elevator; one freight elevator                                                                                                                                                                         |
| <b>Zoning:</b>        | CB (SeaTac)                                                                                                                                                                                                          |
| <b>Transit:</b>       | <ul style="list-style-type: none"><li>• Building is on Metro bus route 180 with transit stop adjacent to building</li><li>• Just minutes away from Link light rail station at SeaTac International Airport</li></ul> |

# SECOND FLOOR

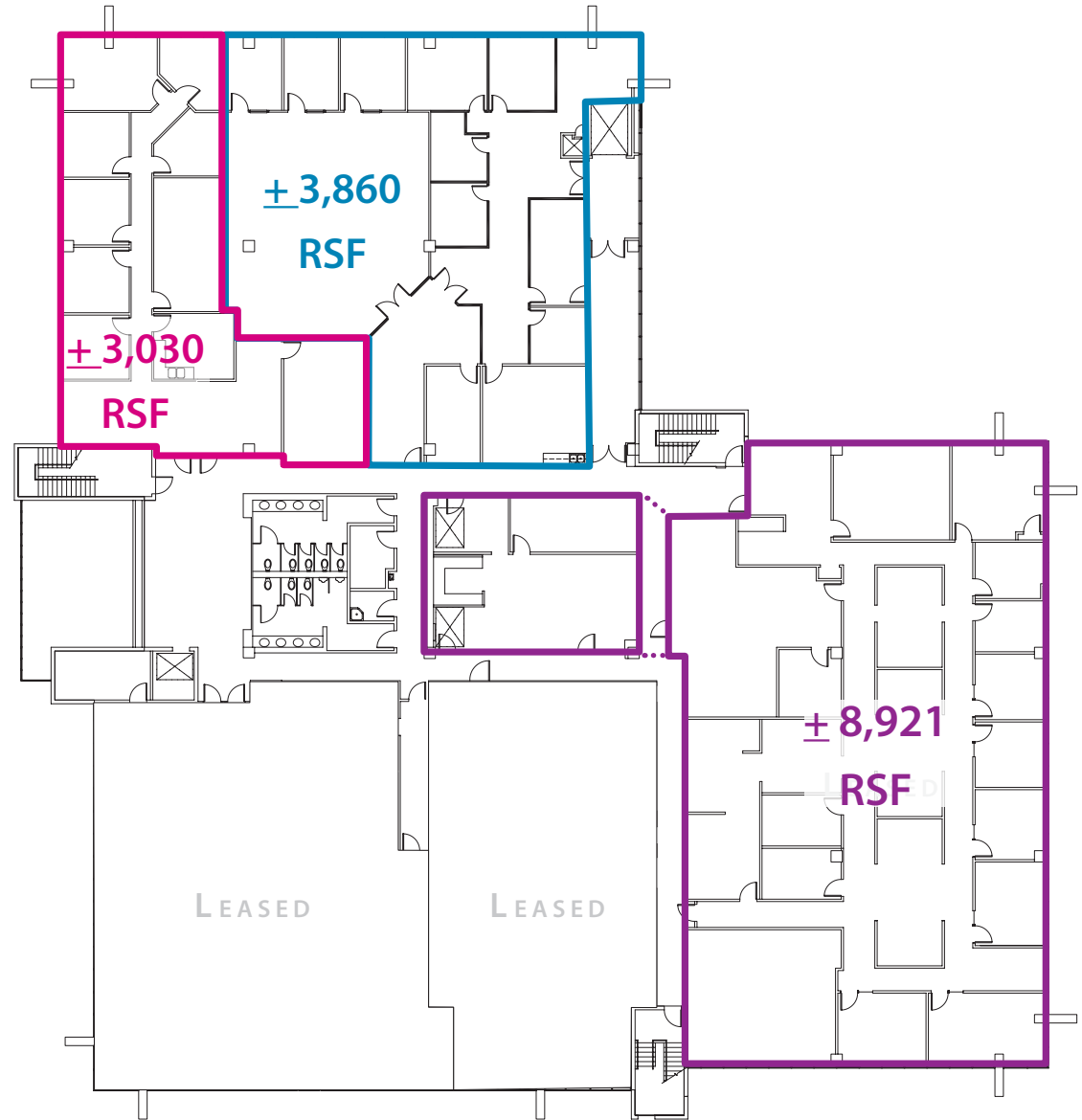

SECOND LEVEL FLOOR PLAN

# NEIGHBORING AMENITIES

