

10 EAST BURNSIDE AVENUE AKA 2036 JEROME AVENUE



SPACE A - 10 EAST BURNSIDE AVENUE

SPACE B - 2036 JEROME AVENUE

SPACE DETAILS

LOCATION

Southeast corner of Jerome Avenue

SPACE

Space A - 10 East Burnside Avenue

Ground Floor	8,453 SF*
Lower Level	12,265 SF*

Space B - 2036 Jerome Avenue

Ground Floor	3,812 SF*
--------------	-----------

*Spaces can be combined

FRONTAGE

Space A - 10 East Burnside Avenue

70 FT 8 IN on East Burnside Avenue

Space B - 2036 Jerome Avenue

64 FT 3 IN on Jerome Avenue

TERM

Negotiable

POSSESSION

Space A - 10 East Burnside Avenue

Arranged

Space B - 2036 Jerome Avenue

February 1, 2018

SITE STATUS

Space A - 10 East Burnside Avenue

Currently Foot Locker

Space B - 2036 Jerome Avenue

Currently Burger King

NEIGHBORS

Rainbow, Payless ShoeSource, Chase, Jimmy Jazz, Wing Stop and Rite-Aid

COMMENTS

Located on the corner of Jerome Avenue in a busy shopping district

Adjacent to the Burnside Avenue  train with 3,617,308 riders annually

Spaces A and B were previously combined

GROUND FLOOR

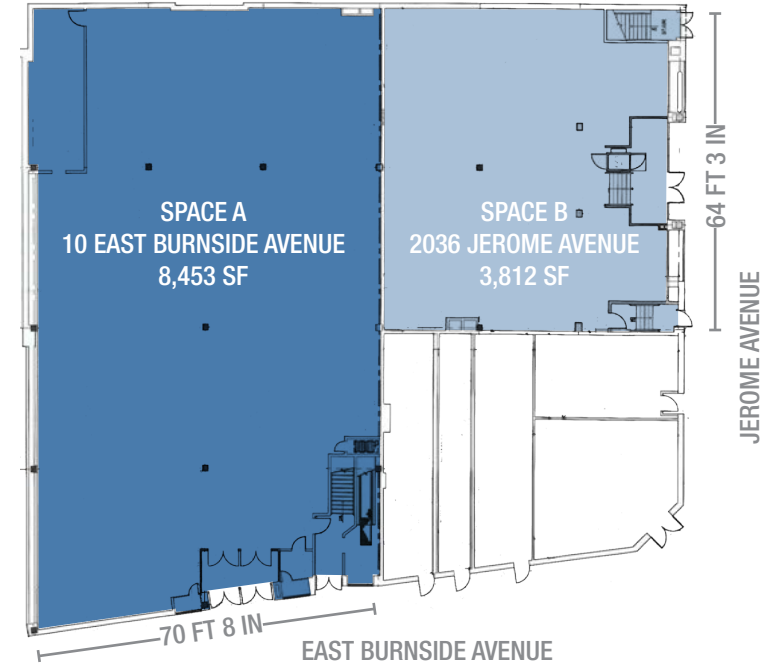

LOWER LEVEL



AREA RETAIL



10
**EAST
BURNSIDE**
AVENUE
BRONX NY

CONTACT
EXCLUSIVE
AGENTS

BARRY FISHBACH
212.331.0115
bfishbach@rkf.com

YOUNG KIM
212.351.9355
ykim@rkf.com



521 FIFTH AVENUE
FLOOR 7
NEW YORK, NY 10175
212.599.3700
INFO@RKF.COM
RKF.COM

© 2017 ROBERT K. FUTTERMAN & ASSOCIATES, LLC All information is from sources believed reliable, not independently verified, and thus subject to errors, omissions, and modifications such as price, listing, square footage, rates and commissions. All information, estimates and projections subject to change, market assumptions, unknown facts and conditions, and future potentialities. RKF makes no express or implied representations or warranties, as facts and results may vary materially from all information, estimates and projections.

All renderings presented are conceptual.