

28990 S. WIXOM ROAD
WIXOM, MICHIGAN

INDUSTRIAL FOR LEASE
6,400-8,900 Square Feet Available



**SIGNATURE
ASSOCIATES**
KNOW SIGNATURE | KNOW RESULTS



PROPERTY FEATURES

- 6,400-8,900 square feet available
- 1,000 square feet of office
- Wixom Rd frontage and signage
- Ideal for auto/truck repair, retail, or industrial use
- 2-3 acres of fenced outside storage (zoned heavy industrial)
- (4) 12x14 grade level doors
- 3-phase power
- Lease Rate: \$9.50/sf NNN



For more information, please contact:

JIM MONTGOMERY
(248) 359 0614
jmontgomery@signatureassociates.com

SIGNATURE ASSOCIATES
One Towne Square, Suite 1200
Southfield, MI 48076
www.signatureassociates.com

28990 S. Wixom Road - Wixom, Michigan

Industrial For Lease

6,400-8,900
Square Feet
AVAILABLE

Site Plan

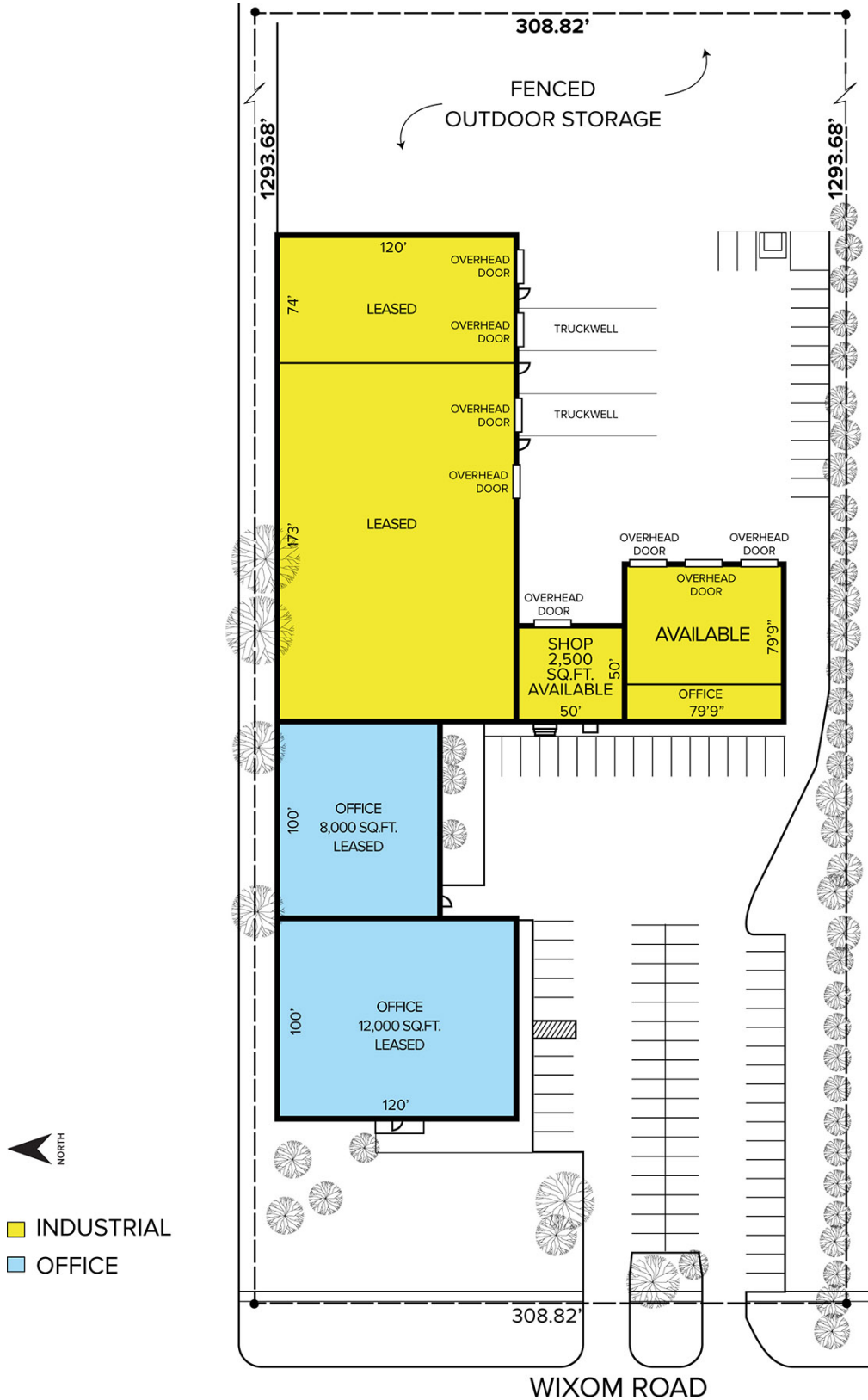

For more information, please contact:

JIM MONTGOMERY
(248) 359 0614
jmontgomery@signatureassociates.com

SIGNATURE ASSOCIATES
One Towne Square, Suite 1200
Southfield, MI 48076
www.signatureassociates.com

28990 S. Wixom Road - Wixom, Michigan

Industrial For Lease

6,400-8,900
Square Feet
AVAILABLE

Aerial



For more information, please contact:

JIM MONTGOMERY

(248) 359 0614

jmontgomery@signatureassociates.com

SIGNATURE ASSOCIATES

One Towne Square, Suite 1200

Southfield, MI 48076

www.signatureassociates.com