

SUFFOLK PLAZA SHOPPING CENTER
900 – 1000 NORTH MAIN STREET
SUFFOLK, VA 23434

FOR LEASE



**1,193 – 3,750 SF IN-LINE
NOW AVAILABLE!**

- Tenants include Chick-fil-A, Big Lots, Citi Trends, Schewels Furniture, The Athlete's Foot, Boost Mobile, CATO, CHKD Thrift Store and Dollar Tree.
- Located on North Main Street.



DEMOGRAPHICS (2017 ESRI):

	1 MI	3 MI	5 MI
Population	4,164	36,109	45,674
Households	1,684	13,073	16,602
Avg. HH Income	\$61,852	\$62,282	\$67,061

FOR MORE INFORMATION, PLEASE CONTACT:

Christopher Hucke
757.640.2205 (direct) | 757.627.8611 (main)
chucke@slnusbaum.com

S.L. Nusbaum Realty Co. | 1700 Wells Fargo Center | 440 Monticello Avenue | Norfolk, VA 23510 | 757.627.8611 | slnusbaum.com

No warranty or representation, expressed or implied, is made to the accuracy or completeness of the information contained herein, and same is submitted subject to errors, omissions, change of price, rental or other conditions, withdrawal without notice, and to any special listing conditions imposed by the property owner(s). As applicable, we make no representation as to the condition of the property (or properties) in question.

SUFFOLK PLAZA SHOPPING CENTER

900 – 1000 NORTH MAIN STREET
SUFFOLK, VA 23434

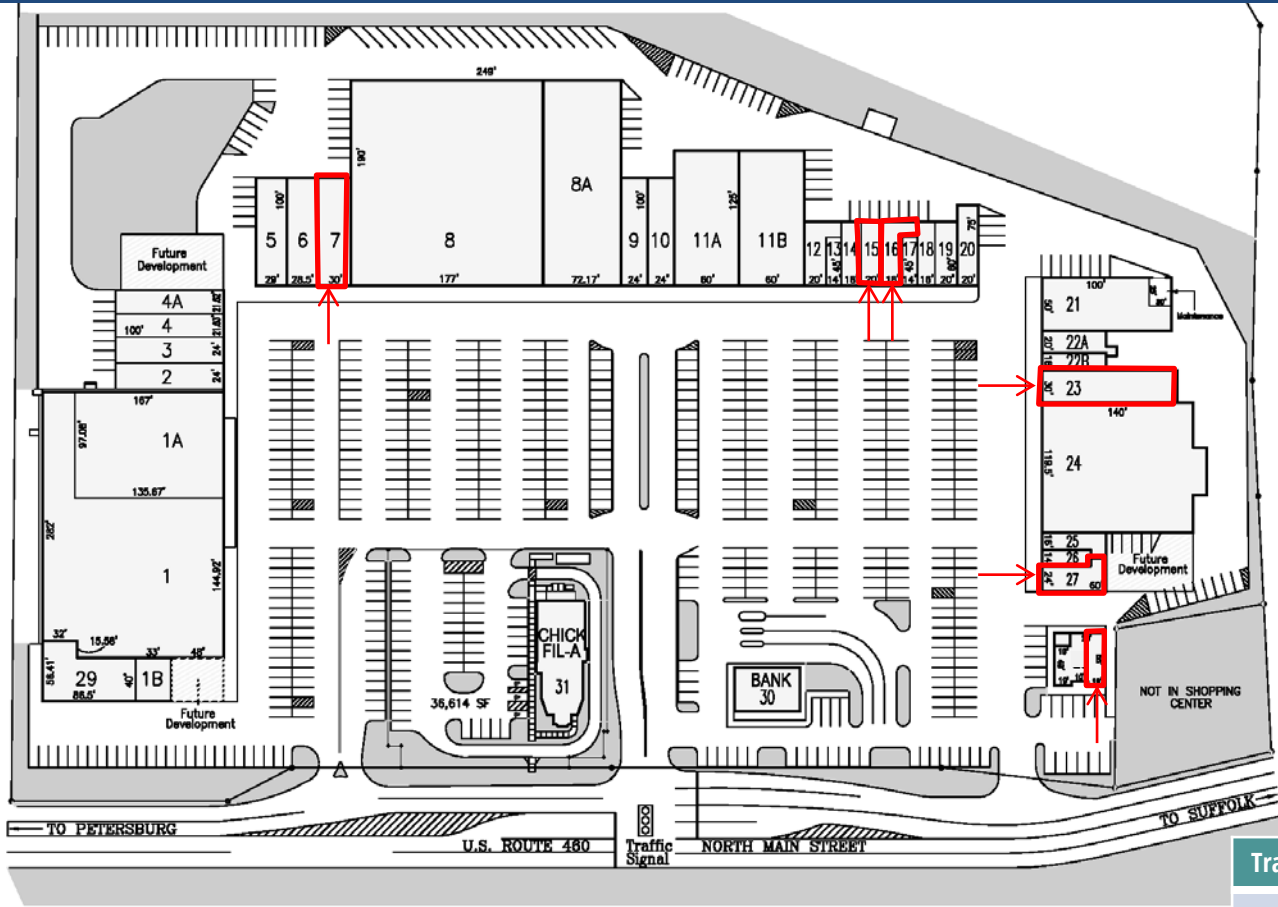

AVAILABLE:	
Unit 7	3,000 SF
Unit 15	1,200 SF
Unit 16	1,290 SF
Unit 23	3,750 SF
Unit 27	1,545 SF
Unit 28	1,193 SF

Traffic Counts at North Main Street (2017 VDOT):	
Bus US 58/Bus US 460 to Old NCL Suffolk	29,000

FOR MORE INFORMATION, PLEASE CONTACT:

Christopher Hucke
757.640.2205 (direct) | 757.627.8611 (main)
chucke@slnusbaum.com

S.L. Nusbaum Realty Co. | 1700 Wells Fargo Center | 440 Monticello Avenue | Norfolk, VA 23510 | 757.627.8611 | slnusbaum.com

No warranty or representation, expressed or implied, is made to the accuracy or completeness of the information contained herein, and same is submitted subject to errors, omissions, change of price, rental or other conditions, withdrawal without notice, and to any special listing conditions imposed by the property owner(s). As applicable, we make no representation as to the condition of the property (or properties) in question.