

RETAIL FOR LEASE

THE
WATERFRONT

VANCOUVER • WASHINGTON

Columbia Way & Grant Street

R I V E R W E S T
—
V A N C O U V E R



RiverWest is a stunning 7-story mixed use building located in the epicenter of the Vancouver Waterfront. Slated for completion in early 2019, this 206 unit project offers unparalleled retail opportunities in this majestic setting. Just steps from the newly constructed cable stay pier, RiverWest fronts Waterfront Park with expansive views of the Columbia River.

FEATURES

22,383 RSF of retail space at RiverWest, a new mixed-use building in the heart of the Vancouver Waterfront

Superior location within the 22 block \$1.5 billion Vancouver Waterfront project

Consistent pedestrian traffic driven by this premium location adjacent to high-volume restaurants, apartments, offices and the \$30 million Waterfront Park

High ceilings, expansive storefront windows, and restaurant infrastructure in place. Flexible configurations- call leasing team for details

Learn More: thewaterfrontvancouverusa.com

CONTACT

Sara Daley
503.721.2726
sdaley@kiddermathews.com

Corine Nussmeier
503.721.2724
corinen@kiddermathews.com

 **Kidder
Mathews**

FOR LEASE

THE
WATERFRONT
VANCOUVER • WASHINGTON



PROJECT HIGHLIGHTS



FIRST-CLASS LOCATION

Class A+ retail in the heart of this stunning development builds on the momentum of downtown Vancouver



DENSITY & DIVERSITY OF USES

3,300 housing units, 1.25 million SF office, and 250,000 SF retail are planned for the district



UNRIVALED DESTINATION

Thousands of residents, employees, and visitors will enjoy the vibrancy of this unique urban destination framed in a spectacular natural setting



ACCESSIBILITY

The Waterfront is an extension of Vancouver's downtown core with immediate access to I-5, Hwy 14, City Hall, Convention Center, public transportation and abundant on and off-street parking.

DEMOGRAPHICS

	15 min	3 miles	5 miles
Population	784,419	63,793	231,617
Average Household Income	\$82,292	\$63,471	\$70,305
Total Employees	537,096	67,215	137,184



FOR LEASE

THE
WATERFRONT
VANCOUVER • WASHINGTON

RIVERWEST GROUND FLOOR PLAN

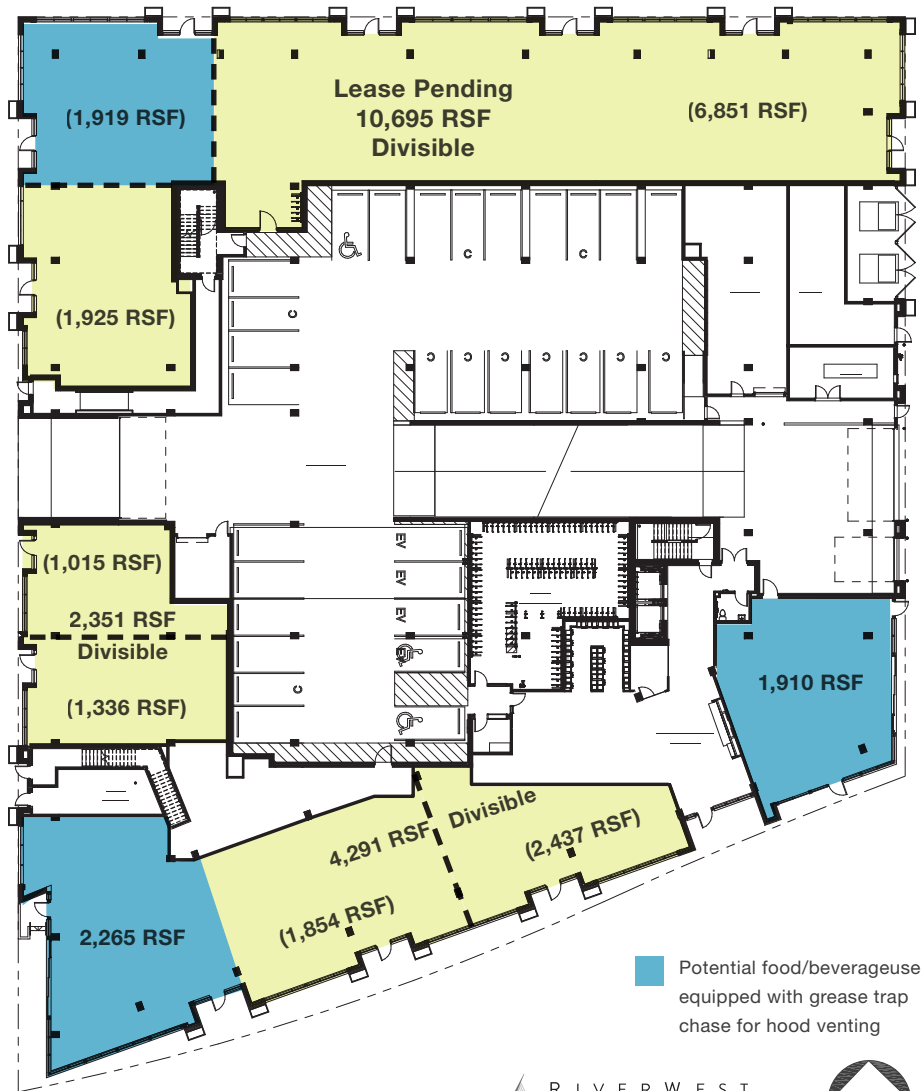

RIVERWEST
VANCOUVER



CONTACT

Sara Daley
503.721.2726
sdaley@kiddermathews.com

Corine Nussmeier
503.721.2724
corinen@kiddermathews.com

FOR LEASE

THE
WATERFRONT
VANCOUVER • WASHINGTON

WATERFRONT VITALS

PHASE I DEVELOPMENT

BLOCKS 9 & 12
2 restaurant buildings
totaling 45,582 SF
Summer 2018



BLOCK 6
64 apartment units
60,000 SF office
18,250 SF retail
September 2018



BLOCK 4
138 hotel rooms
40 luxury condos
6,600 SF retail
Early 2020



BLOCK 3
251 apartment units
12,500 SF retail
Mid 2020

TIMBERHOUSE



BLOCK 8
206 apartment units
22,384 SF retail/office
Spring 2019



FOR LEASE

THE
WATERFRONT
VANCOUVER • WASHINGTON

AREA MAP



CONTACT

Sara Daley
503.721.2726
sdaley@kiddermathews.com

Corine Nussmeier
503.721.2724
corinen@kiddermathews.com

