

West of NWC Tatum Blvd & Bell Rd

4550 E Bell Road • Phoenix, Arizona



For Lease: \$18.00/SF, \$7.49 NNN

Property Features

- 1,682 SF Suite
- Outstanding visibility to Bell Rd
- Zoning: C-1
- Over 85,000 SF of office in the immediate area to complement the retail component
- Convenient left-in and left-out turn access to Bell Rd
- Within one (1) mile of:
 - SR 51 with full diamond on/off ramps
 - Paradise Valley Hospital
 - Paradise Valley High School
- Dense residential and daytime population in the surrounding area

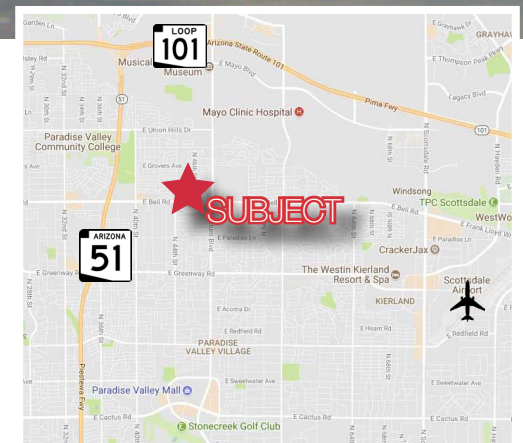

NAI Horizon naihonorizon.com

All information furnished regarding property for sale, rental or financing is from sources deemed reliable, but no warranty or representation is made to the accuracy thereof and same is submitted subject to errors, omissions, change of price, rental or other conditions prior to sale, lease or financing or withdrawal without notice. No liability of any kind is to be imposed on the broker herein.

Chris Gerow
Senior Vice President
602 852 3413 direct
602 956 5726 direct fax
chris.gerow@naihonorizon.com

Gabe Ortega
Vice President
602 852 3415 direct
602 956 5726 direct fax
gabe.ortega@naihonorizon.com

Shelby Tworek
First Vice President
602 667 1797 direct
602 956 5726 direct fax
shelby.tworek@naihonorizon.com

Patrick Anthon
Associate
602 393 6662 direct
602 956 5726 direct fax
patrick.anthon@naihonorizon.com

West of NWC Tatum Blvd & Bell Rd

4550 E Bell Road • Phoenix, Arizona

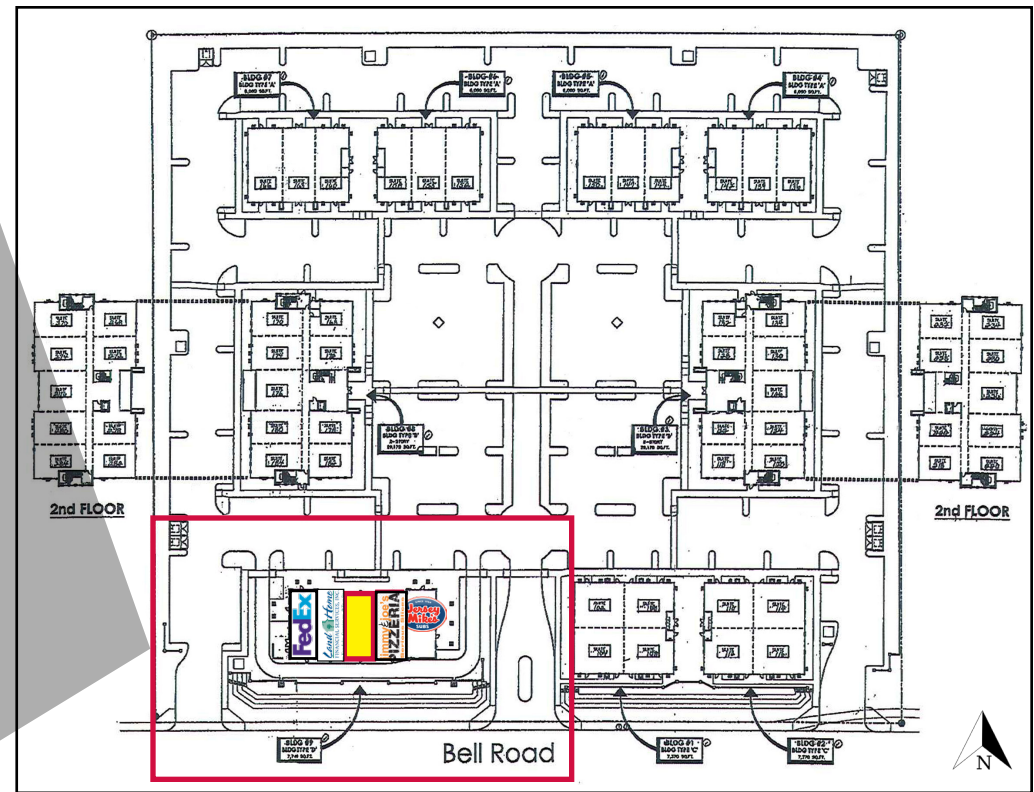
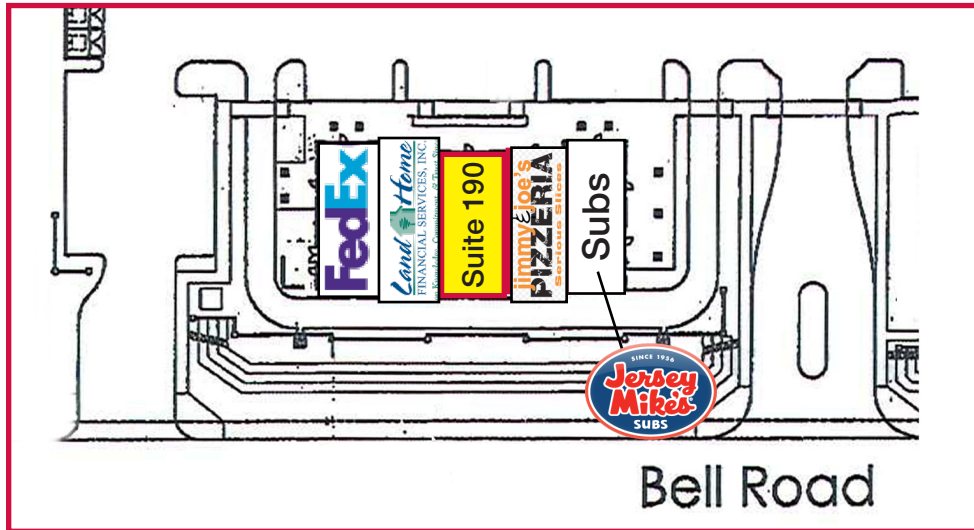

Bell Road Frontage



Suite 190

AVAILABLE

SUITE 190
± 1,682 SF

DO NOT DISTURB



naihorizon.com

Chris Gerow
Senior Vice President
602 852 3413 direct
602 956 5726 direct fax
chris.gerow@naihorizon.com

Gabe Ortega
Vice President
602 852 3415 direct
602 956 5726 direct fax
gabe.ortega@naihorizon.com

Shelby Tworek
First Vice President
602 667 1797 direct
602 956 5726 direct fax
shelby.tworek@naihorizon.com

Patrick Anthon
Associate
602 393 6662 direct
602 956 5726 direct fax
patrick.anthon@naihorizon.com

1,682 SF Suite for Lease in Multi-Use Development

West of NWC Tatum Blvd & Bell Rd

4550 E Bell Road • Phoenix, Arizona



Demographics	1 Mile	3 Miles	5 Miles
• Estimated Population (2017)	16,873	119,239	243,087
• Projected Population (2022)	18,115	128,636	262,322
• Median HH Income (2017)	\$72,685	\$65,207	\$66,977
• Median Age (2017)	39.6	38.7	39.7