

COMMERCIAL LEASING SERVICES

RIGHT SPACE | RIGHT PLACE



AVAILABLE SPACE

PRESENTED BY

Fred Barajas

Commercial Associate

909-725-3434

DIC Lic. #01994577

Michael G. Rademaker

President / Broker

909-579-1340

DIC Lic. #00556679

1901 Orange Tree Ln. Redlands, CA 92374

This two-story office building has a very attractive and modern building design. The lobby and hallways have been upgraded for the professional image you desire. Restrooms have granite counters and tile flooring.

Convenient and close to the I-10, I-210 & I-215 freeways. Ontario International Airport is only 20 minutes west of the property.

Available For Lease:

Suite 260 : 657 +/- Sq. Ft.

Open floor plan, I.T. / Storage Cabinet, Coffee bar and One Office

To view this space, please call for an appointment.



MGR
Real Estate

3800 Concourse St., Ste. 350

Ontario, CA. 91764

909.981.4466 ph

909.981.6267 fax

All items on this page are deemed to be accurate, but should be viewed as reference only. MGR Real Estate, Inc. does not warranty/guaranty the validity of any information on this page.

COMMERCIAL LEASING SERVICES

RIGHT SPACE | RIGHT PLACE

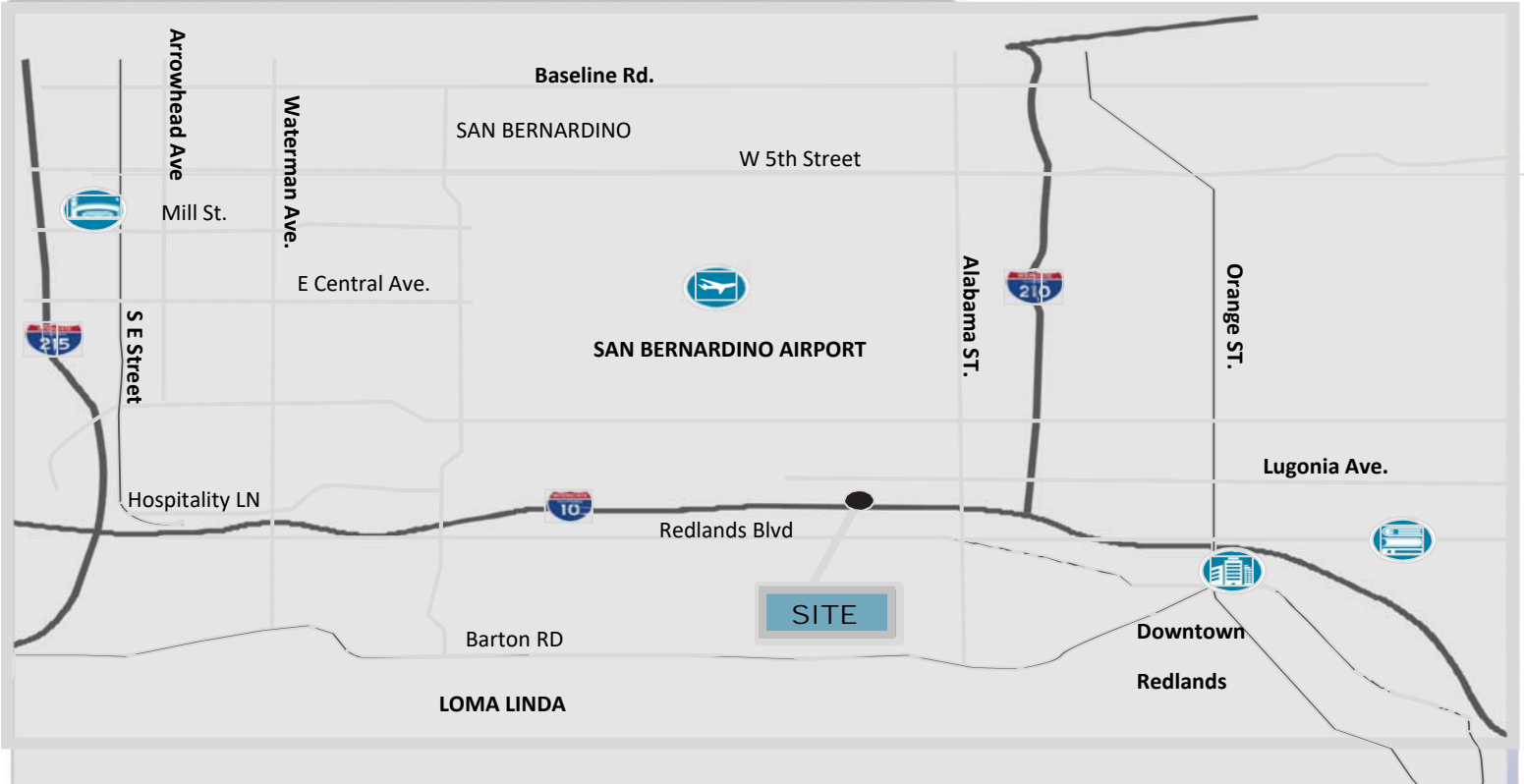

1901 Orange Tree Ln., Suite 260

Floor Plan
(Floor Plan Not to Scale)

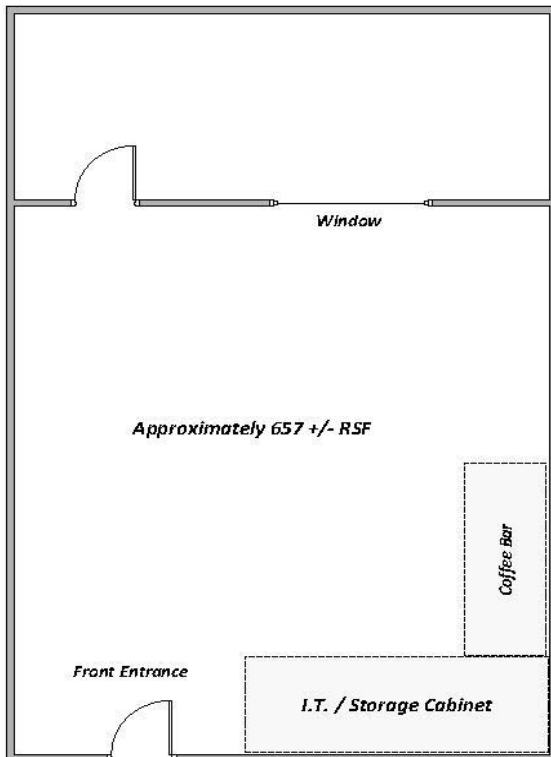

All items on this page are deemed to be correct but should be viewed as reference only. MGR Real Estate, Inc. does not warranty/guaranty the validity of any information on this page.



3800 Concour St., Ste. 350
Ontario, CA. 91764
909.981.4466 ph
909.981.6267 fax