

FOR LEASE

1734 - 1774 BUILDTEK COURT

Las Cruces, New Mexico

Facility Information

- Space available from 7,250 - 45,529 sf
- 19' Height
- Partial sprinkler fire suppression system
- Ample off-street parking
- Two (2) miles to Interstate 10 access
- Pre-cast concrete tilt-up construction
- Roll-up overhead doors: 9' x 12'
14' x 14'
20' x 14'

Property Description

Located two miles from I-10, this property has ample off street parking with easy access to truck docks. The area available ranges from 7,250 to 45,529 sf of flexible space.



Interior Warehouse Space



Rear Opens to 1764

Lease Information

- \$6.00 PSF (NNN)
- Estimated Insurance: \$0.18 ± psf
- Estimated Taxes: \$0.36 ± psf

For more information, contact:

Jacob Slavec

+ 575 644 8529
jacob@1stvalley.com

NAI 1st Valley

Commercial Real Estate Services, Worldwide.

1155 South Telshor
Las Cruces, NM 88011
+1 575 521 1535

1stvalley.com

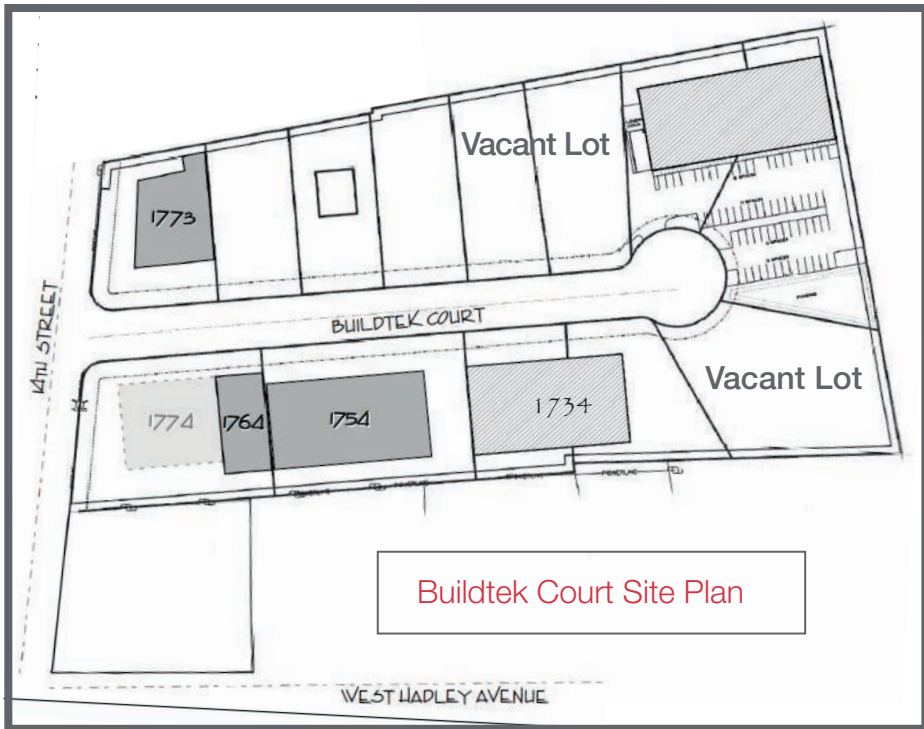

NO WARRANTY OR REPRESENTATION, EXPRESS OR IMPLIED, IS MADE AS TO THE ACCURACY OF THE INFORMATION CONTAINED HEREIN, AND THE SAME IS SUBMITTED SUBJECT TO ERRORS, OMISSIONS, CHANGE OF PRICE, RENTAL OR OTHER CONDITIONS, PRIOR SALE, LEASE OR FINANCING, OR WITHDRAWAL WITHOUT NOTICE, AND OF ANY SPECIAL LISTING CONDITIONS IMPOSED BY OUR PRINCIPALS NO WARRANTIES OR REPRESENTATIONS ARE MADE AS TO THE CONDITION OF THE PROPERTY OR ANY HAZARDS CONTAINED THEREIN ARE ANY TO BE IMPLIED.

1773
 Approx.
 2,000 ± sf
 Available

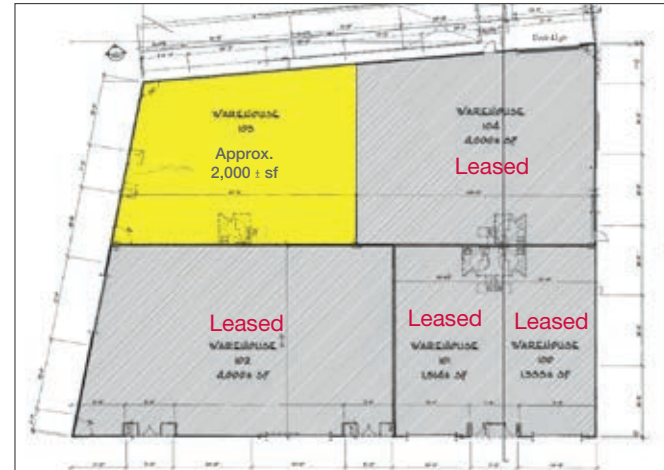

BUILDTEK COURT 1734

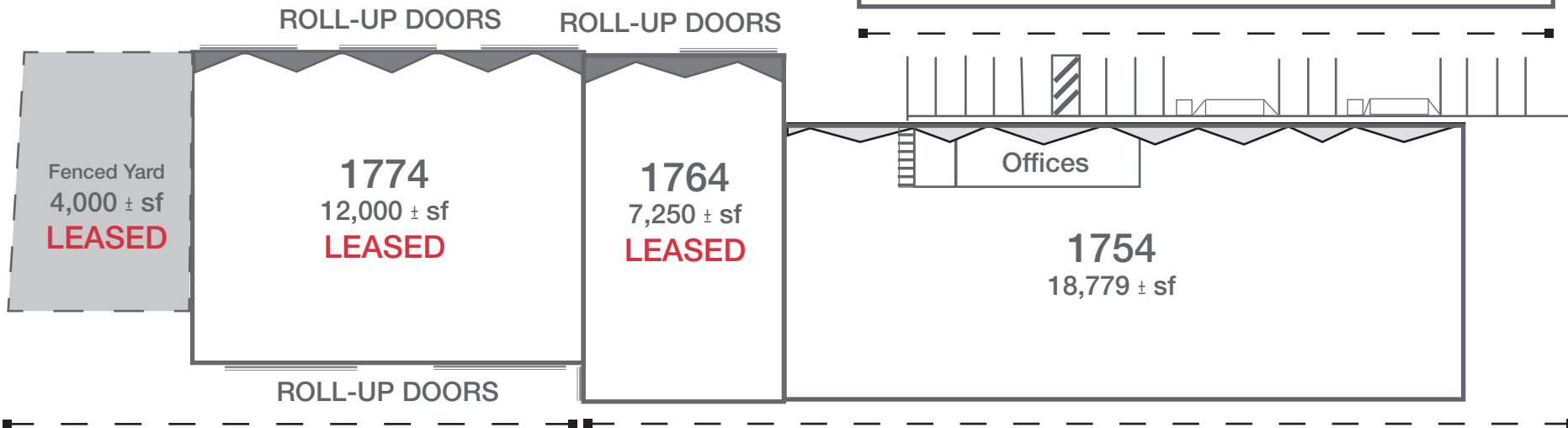
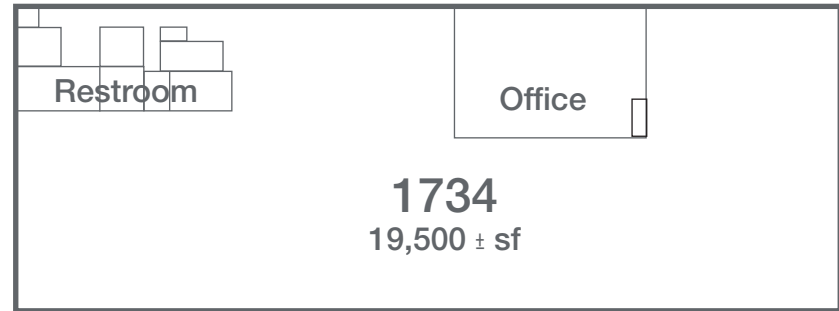

BUILDTEK COURT 1774 • 1773 • 1764 • 1754 • 1734

INDUSTRIAL PROPERTY FOR LEASE