

FOR LEASE

TRENTON BUSINESS CENTER

6105

TRENTON LANE NORTH

Plymouth, MN



PROPERTY FEATURES

- + Single tenant office/warehouse building located in Bass Creek business park in Plymouth
- + Amenities include conference and training rooms, passenger elevator, cafeteria, and employee fitness center
- + Built in 1994; situated on 12 acres
- + Quick, direct access from Hwy 169, west on Bass Lake Road and just blocks north on Nathan Lane North

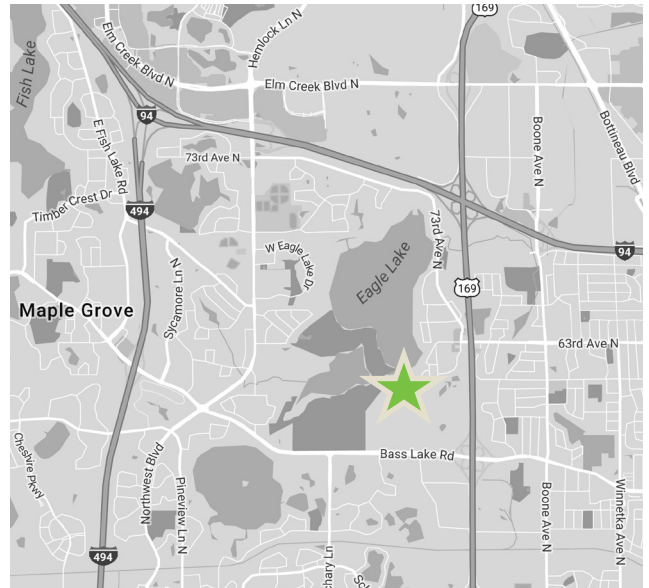

CONTACT US

JOHN RYDEN

Senior Vice President
+1 952 924 4641
john.ryden@cbre.com

MATT OELSCHLAGER

Senior Vice President
+1 952 924 4848
matt.oelschlagel@cbre.com

MIKE BOWEN

Senior Associate
+1 952 924 4885
mike.bowen@cbre.com

www.cbre.com/minneapolis

CBRE

FOR LEASE TRENTON BUSINESS CENTER

6105
TRENTON LANE
NORTH
Plymouth, MN

Total Building SF	122,032 SF
Office SF	54,206 SF 28,453 SF Main Level 25,753 SF 2nd Floor
Warehouse SF	67,826 SF (100% A/C)
Loading	23 dock doors (8'x10') 1-(10x10) 1 drive-in door (14'x12')
Clear Height	24'
Column Spacing	40' x 40'
Lighting	LED
Power	1200A, 480V, 3PH
Sprinklered	ESFR
Parking	281 (2.3/1000)
Lease Rates	\$4.75/\$8.75 PSF
2018 Est. Expenses	\$3.21 Total (\$2.15 PSF Taxes/\$1.06 PSF CAM)

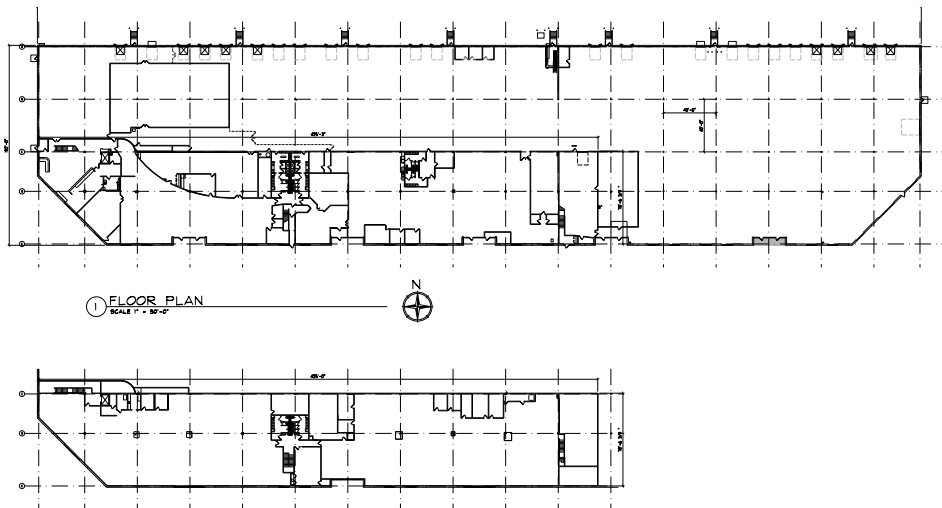

© 2017 CBRE, Inc. This information has been obtained from sources believed reliable. We have not verified it and make no guarantee, warranty or representation about it. Any projections, opinions, assumptions or estimates used are for example only and do not represent the current or future performance of the property. You and your advisors should conduct a careful, independent investigation of the property to determine to your satisfaction the suitability of the property for your needs. CBRE and the CBRE logo are service marks of CBRE, Inc. and/or its affiliated or related companies in the United States and other countries. All other marks displayed on this document are the property of their respective owners.

Photos herein are the property of their respective owners and use of these images without the express written consent of the owner is prohibited.