

1754 MAPLELAWN DRIVE  
TROY, MICHIGAN

HI-TECH FOR LEASE  
3,840 Square Feet Available



**SIGNATURE  
ASSOCIATES**  
KNOW SIGNATURE | KNOW RESULTS

**TROY MOTOR MALL**



## PROPERTY FEATURES

- 3,840 square feet available
- 2,240 square feet of office
- 18' clear height
- (1) 12x14 grade level door
- Zoned I-1
- Very nice office space with furniture
- Some of the large high ceiling meeting/open office area could be converted to warehouse
- Additional warehouse could also be made available
- Lease Rate: \$9.95/sf Gross



For more information, please contact:

**KRIS PAWLOWSKI**  
(248) 359 3801  
kpawlowski@signatureassociates.com

**SIGNATURE ASSOCIATES**  
One Towne Square, Suite 1200  
Southfield, MI 48076  
www.signatureassociates.com

# 1754 Maplelawn Drive – Troy, Michigan

## Hi-Tech For Lease

3,840  
Square Feet  
AVAILABLE

### Site Plan

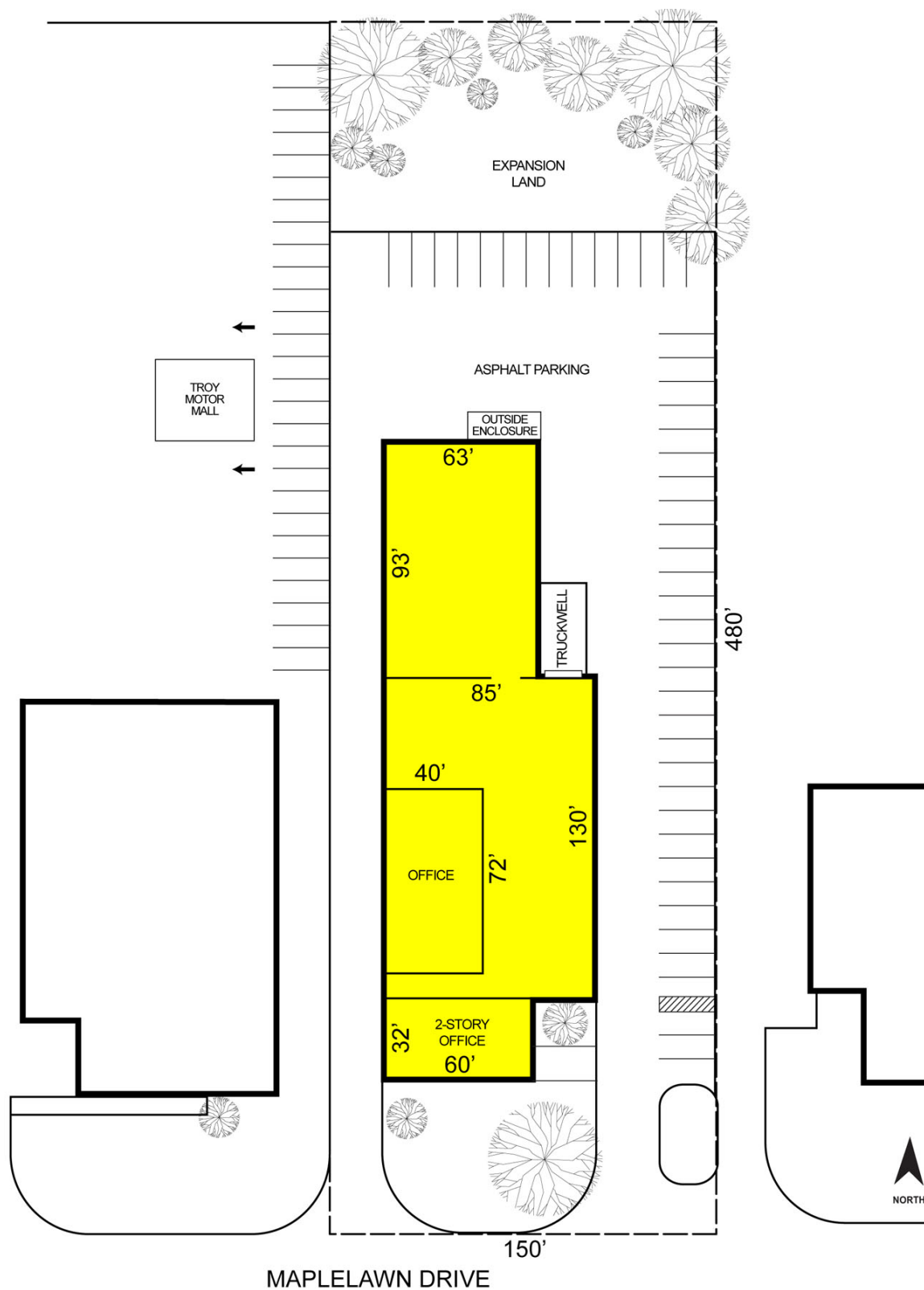

For more information, please contact:

**KRIS PAWLOWSKI**  
(248) 359 3801  
kpawlowski@signatureassociates.com

**SIGNATURE ASSOCIATES**  
One Towne Square, Suite 1200  
Southfield, MI 48076  
www.signatureassociates.com



# 1754 Maplelawn Drive – Troy, Michigan

## Hi-Tech For Lease

3,840  
Square Feet  
AVAILABLE

Aerial



For more information, please contact:

**KRIS PAWLOWSKI**  
(248) 359 3801  
[kpawlowski@signatureassociates.com](mailto:kpawlowski@signatureassociates.com)

**SIGNATURE ASSOCIATES**  
One Towne Square, Suite 1200  
Southfield, MI 48076  
[www.signatureassociates.com](http://www.signatureassociates.com)

Information is subject to verification and no liability for errors or omissions is assumed. Price is subject to change and listing withdrawal.