

# St. Louis Business Center

8000 Hall St | Building 4, Suite E

\*Crane served



## For Lease

**Suite E overview** (available March 2018)

Available space:	±25,000 - 70,805 SF,
Office space:	3,020 SF
Cranes:	Six (6), 15 ton cranes
Clear height:	24' - 30'
Dock doors:	2 (9' x 10')
Drive-in doors:	4 (12' x 14')
Power:	3-phase/600 amp
Clear span bay spacing:	63' - 78'
Fire protection:	ESFR
Security:	Secured business park
Location:	Excellent access to I-70
Asking rate:	\$5.50/SF, NNN

Light Industrial/  
Manufacturing/  
Distribution

**8000 Hall St.  
St. Louis, MO**

**Pat Reilly, SIOR**  
+1 314 338 2085  
patrick.reilly@am.jll.com

**David Branding, SIOR**  
+1 314 338 2084  
david.branding@am.jll.com

[jll.com/stl-ambition](http://jll.com/stl-ambition)



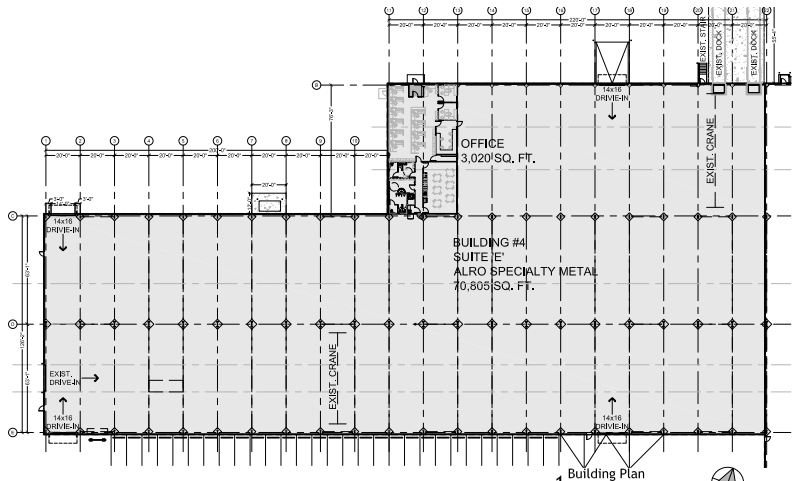

**Building #4 - ALRO STEEL**  
8000 HALL STREET, ST. LOUIS, MO

12.19.16  
SCALE: 1" = 30'-0"  
**TREANORHL**

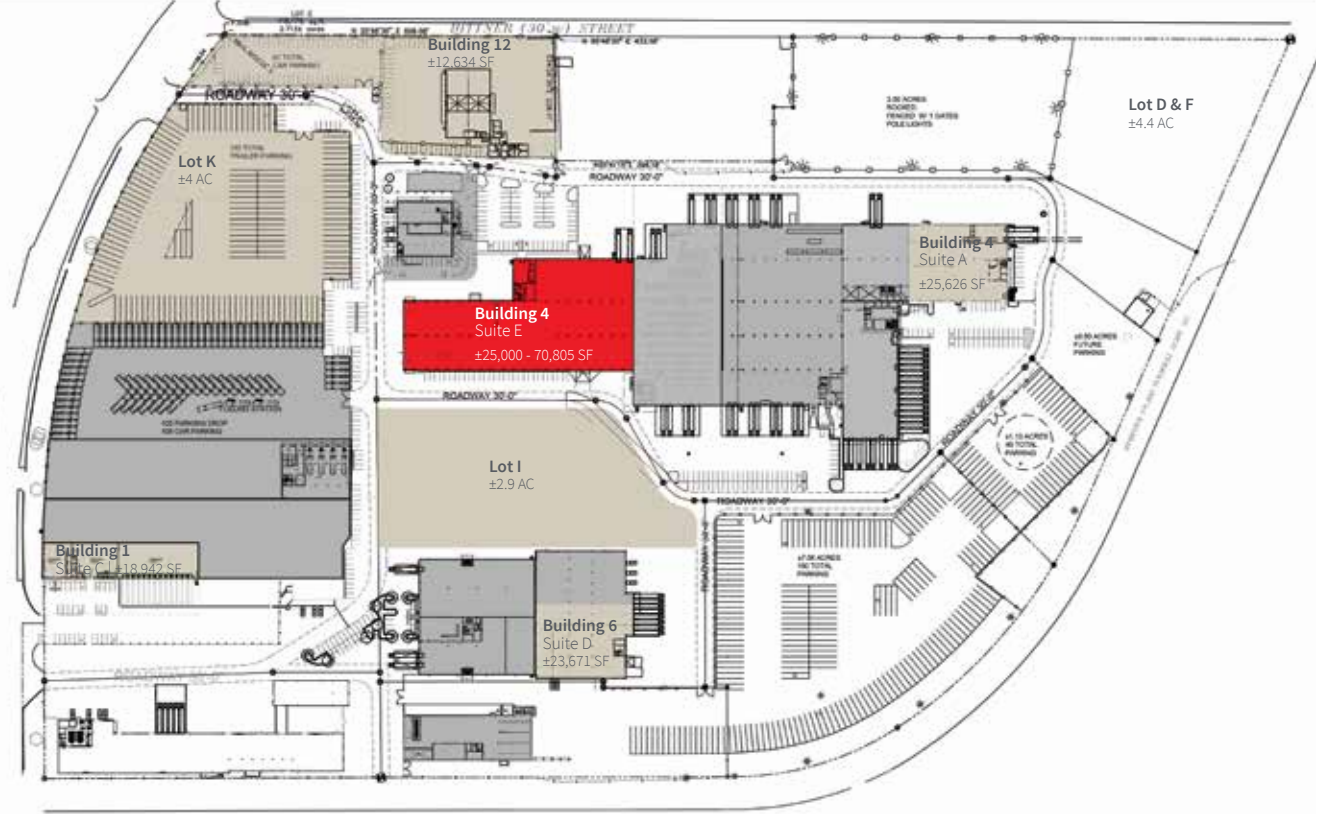
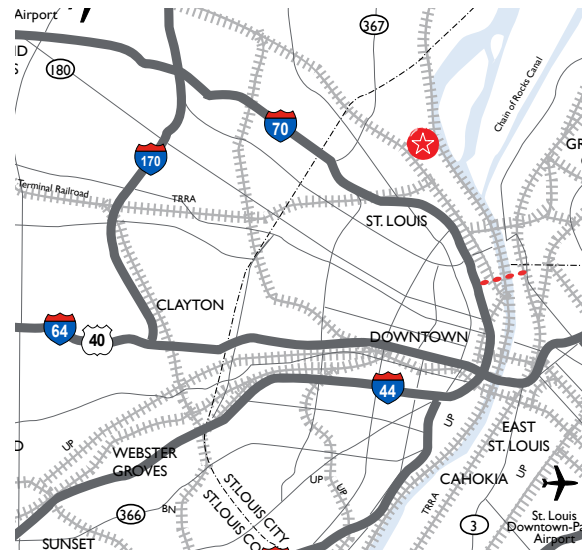

■ Available    ■ Leased    ■ Featured space

**Pat Reilly, SIOR**  
+1 314 338 2085  
patrick.reilly@am.jll.com

**David Branding, SIOR**  
+1 314 338 2084  
david.branding@am.jll.com



**DISCLAIMER**  
© 2017 Jones Lang LaSalle IP, Inc. All rights reserved. All information contained herein is from sources deemed reliable; however, no representation or warranty is made to the accuracy thereof.

